

Source: Streetmix.net

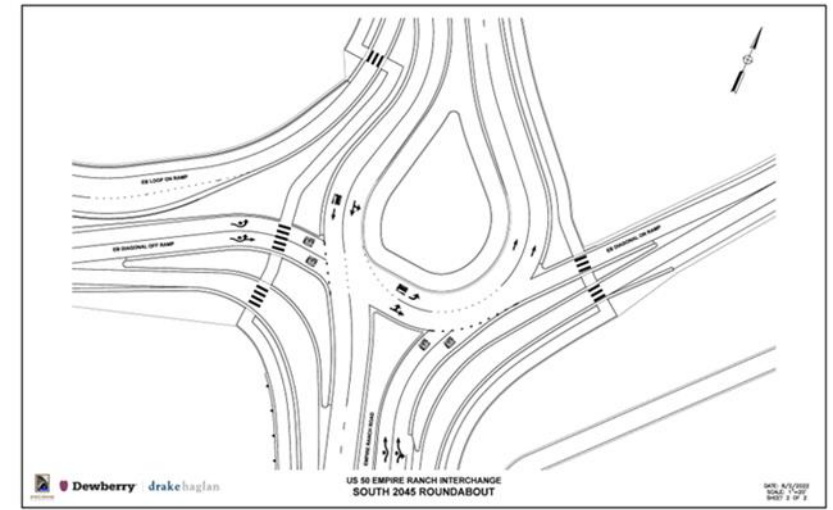

West of Folsom-Auburn Road

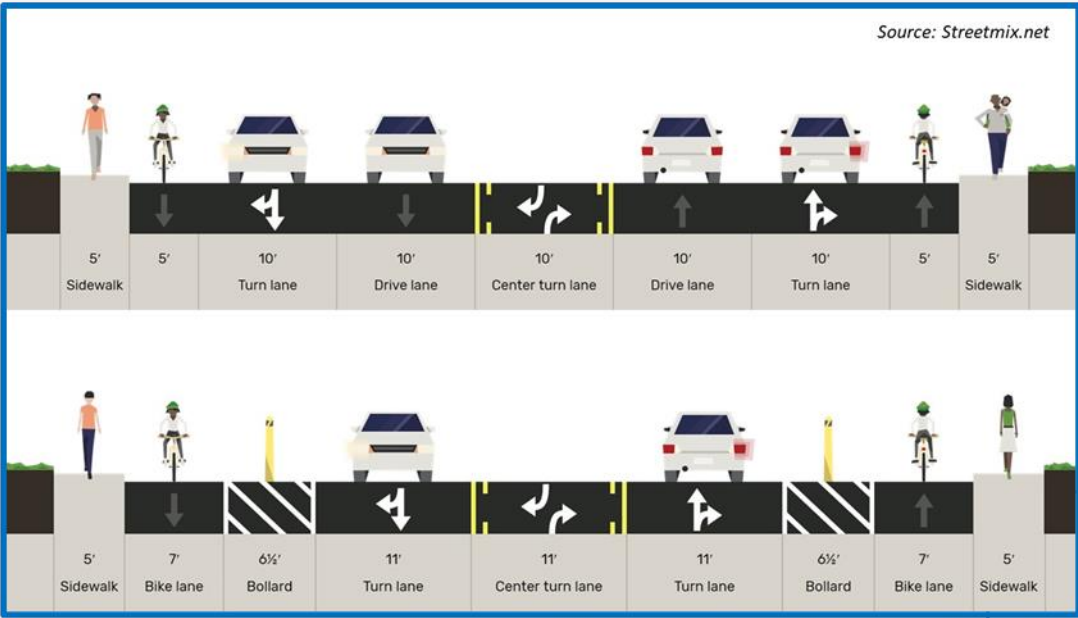
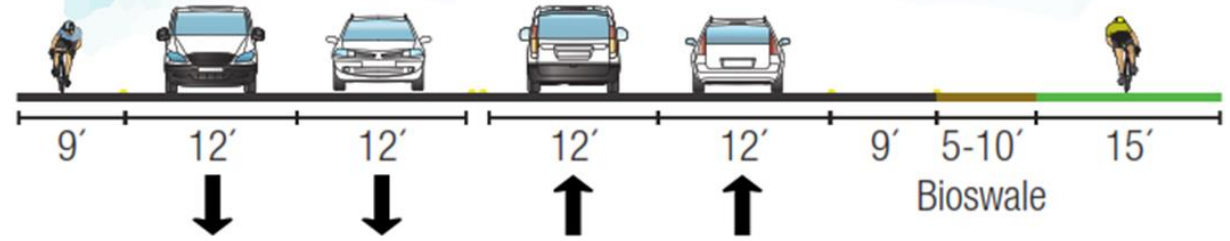

2022/23 SACOG Funding Round

SACOG Funding Round Details



SACOG is ...

- Municipal Planning Organization for six-county Sacramento region
- Transportation Planning Agency for four-county sub region
- Responsible for allocating regional transportation and air quality apportionments

Regional Funding Round

- Approximately \$115M in funding
- Allocated to two main categories: Transformative and Maintenance/Modernization
- Smaller allotment for Community Design Program



Transformative vs. Maintenance/Modernization

Which category is right for your project?

Transformative or Maintenance & Modernization

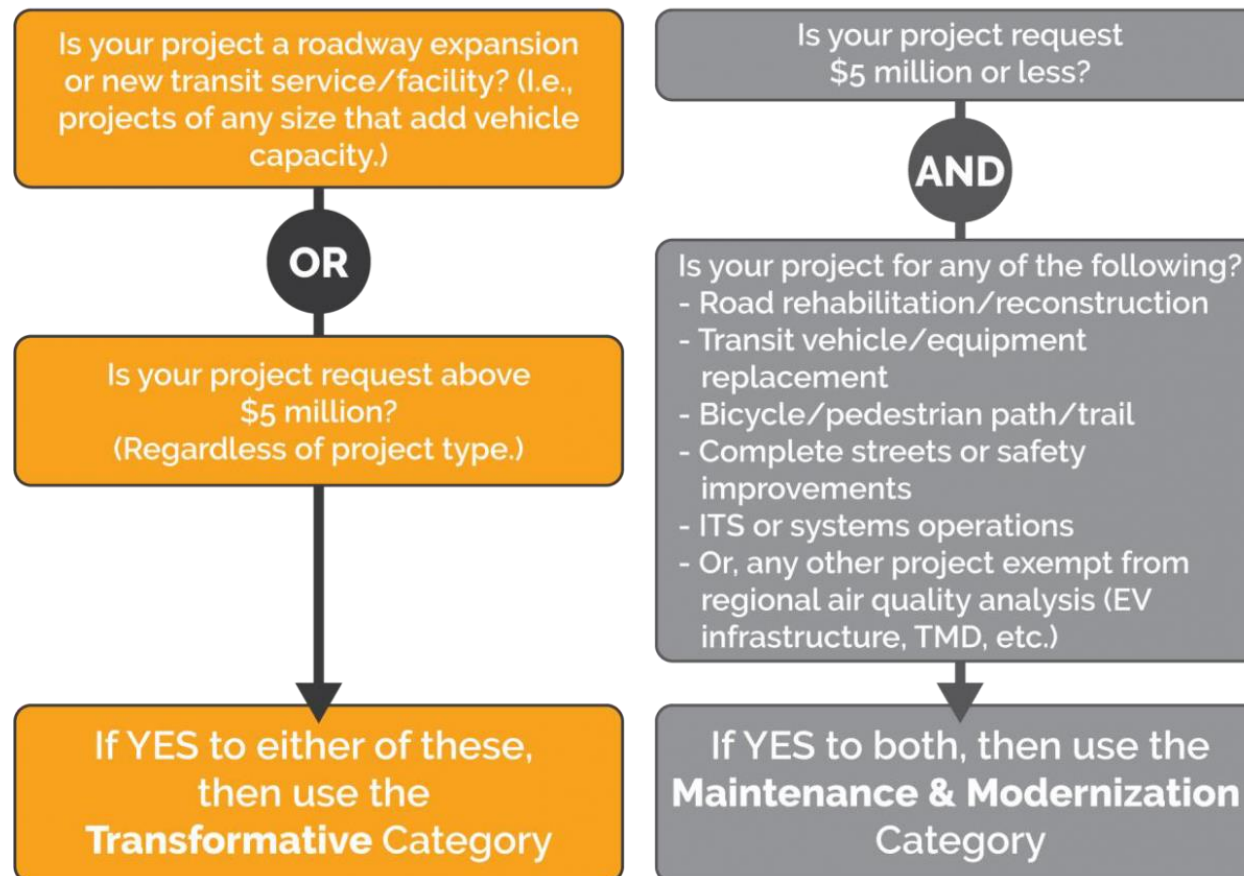

2020/21 Funding Round Results



Project	Description	Category	Requested	Funded
US50/E. Bidwell	Construct triple left turn at Iron Point, add lane to westbound on-ramp	Transformative	\$4.57M	\$4.57M
ITS Master Plan	Fully implement ITS Master Plan	M&M	\$4.35M	\$4.35M
US50/Empire Ranch Interchange	Final design of new interchange	Trans	\$10M	\$2.5M
Natoma Drainage Phase 2	Additional drainage improvements along Natoma Street in Historic District	M&M	\$250k	\$0
Folsom-Placerville Rail Trail	Design Class I trail along SPTC corridor	M&M	\$134k	\$0
Oak Ave Complete Streets	Improve Oak Avenue Parkway between Folsom-Auburn and Baldwin Dam (add bike trail, widen)	M&M	\$655k	\$0
Blue Ravine Pavement Rehab	Fund pavement repairs on Blue Ravine between Prairie City Rd and Oak Avenue Parkway	M&M	\$788k	\$0
Folsom Bl Bike/Ped Overcrossing	Design new overcrossing on Folsom Blvd between Glenn and Blue Ravine	M&M	\$200k	\$0
CBD Streetscape	Planning study to assess streetscape modifications in Central Business District	Comm Design	\$100k	\$100k
Amer. River Canyon Dr Road Diet	Convert American River Canyon Drive between Greenback and Oak Avenue from four to two lanes	M&M	\$2.66M	\$0
		Totals	\$23.71M	\$11.52M

2022/23 Funding Round Candidates



Project Name (initial priority)	Category	Requested	Description
(1) US50/Empire Ranch Interchange	Transformative	\$10M	Phase 1 Construction
(2) Natoma Street Drainage	M&M	\$200k	Design
(3) Folsom-Placerville Rail Trail	M&M	\$1.7M	Construction
(4) Oak Ave Complete Streets	M&M	\$655k	Design/Enviro
(5) Pavement Repair & Rehabilitation	M&M	\$1M	Maintenance
(6) Amer. River Canyon Dr Road Diet	M&M	\$2.66M	Construction
(7) US50/E. Bidwell Trail Undercrossing	M&M (new)	\$3M	Design/Construction
(8) Santa Juanita Ave Curve	M&M (new)	\$250k	Planning/Environmental
(9) RAB Policy Planning Study	Community Design (new)	\$100k-\$200K	Planning
(10) Trail Maintenance	M&M (new)	\$2.0M	Maintenance

**Total "Ask":
\$21.7M**

Project Locations

(1) US50/Empire Ranch Interchange

(2) Natoma Street Drainage

(3) Folsom-Placerville Rail Trail

(4) Oak Ave Complete Streets

(5) E. Bidwell Pavement Rehab

(6) Amer. River Canyon Dr Road Diet

(7) US50/E. Bidwell Trail Undercrossing

(8) Santa Juanita Ave Curve

(9) RAB Policy Planning Study (not pictured)

(10) Trail Maintenance (not pictured)



US50/Empire Ranch Interchange

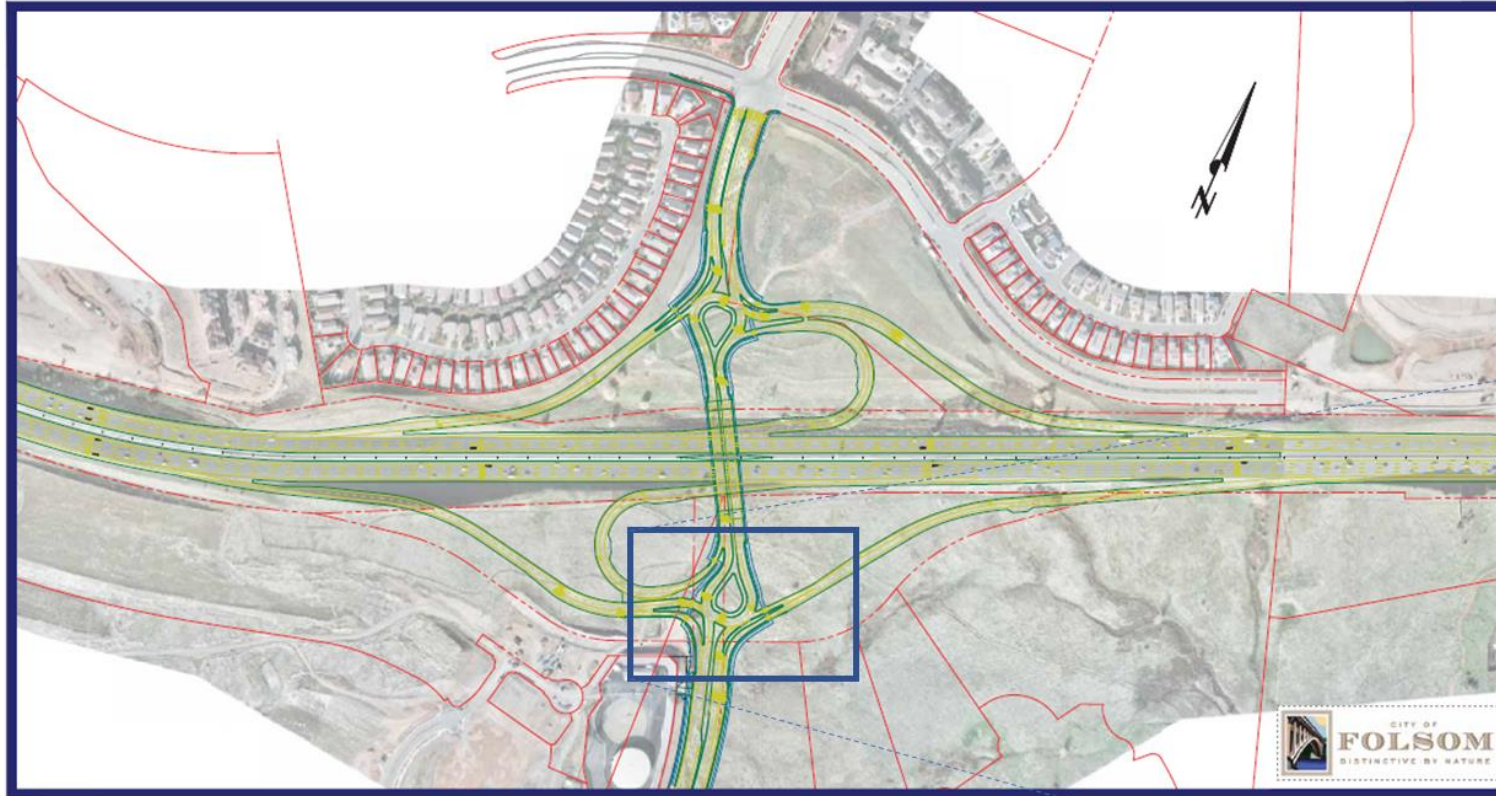

EMPIRE RANCH ROAD/ROUTE 50 INTERCHANGE
ROUNDBOUT INTERSECTION ALTERNATIVE

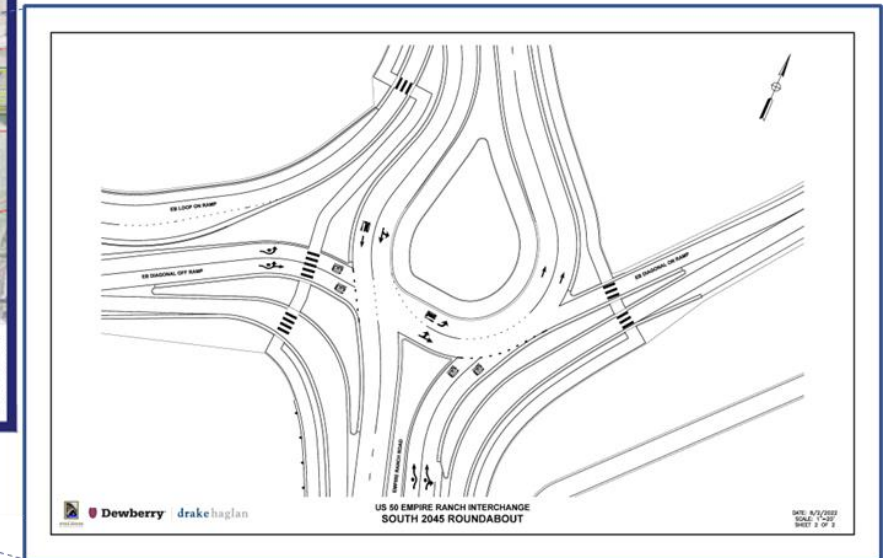

Oak Avenue Parkway Complete Streets Project

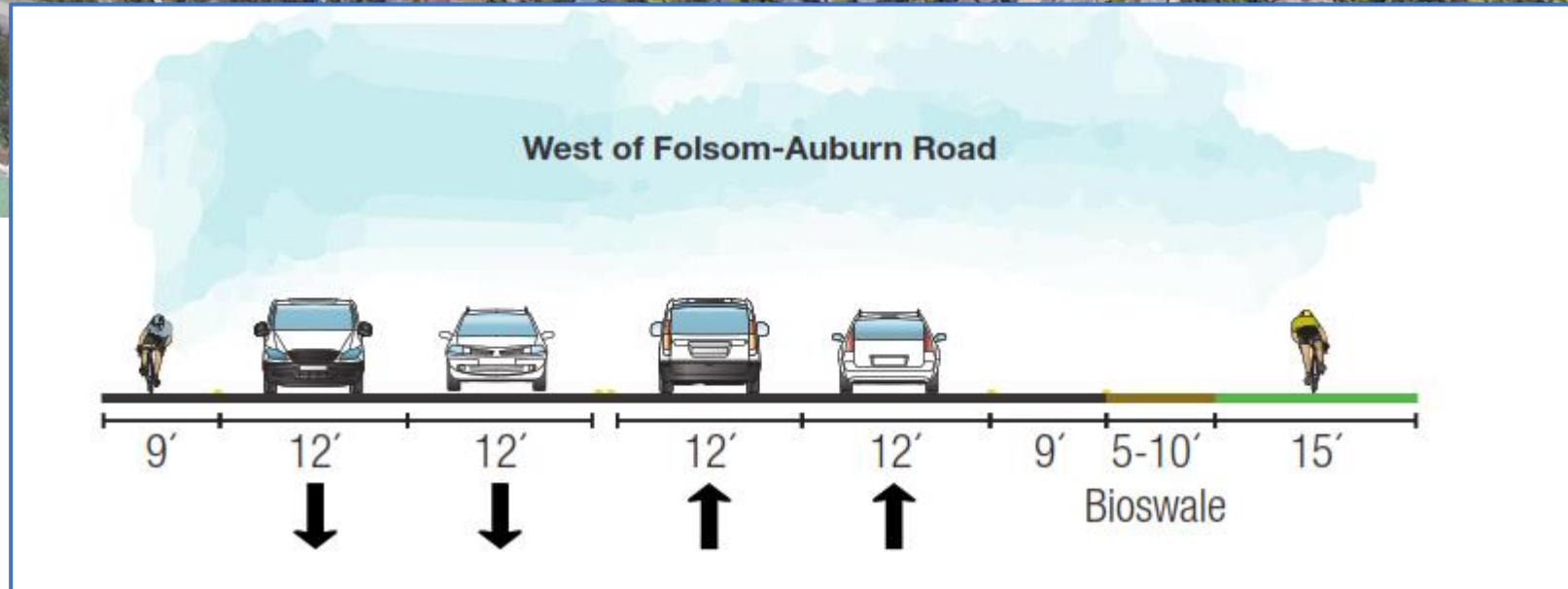
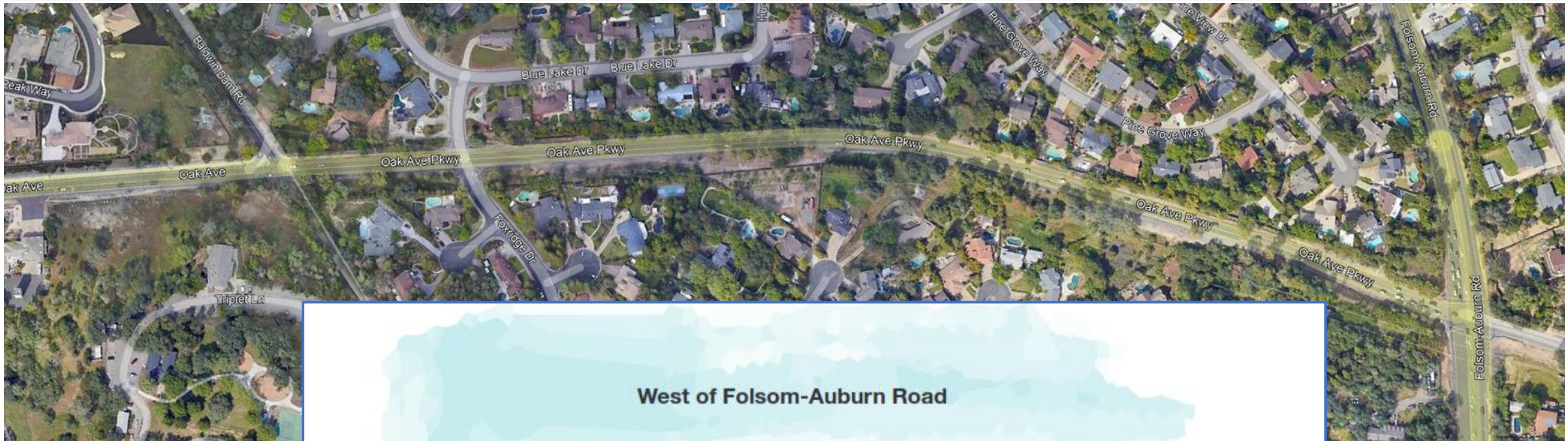

American River Canyon Drive Road Diet Project

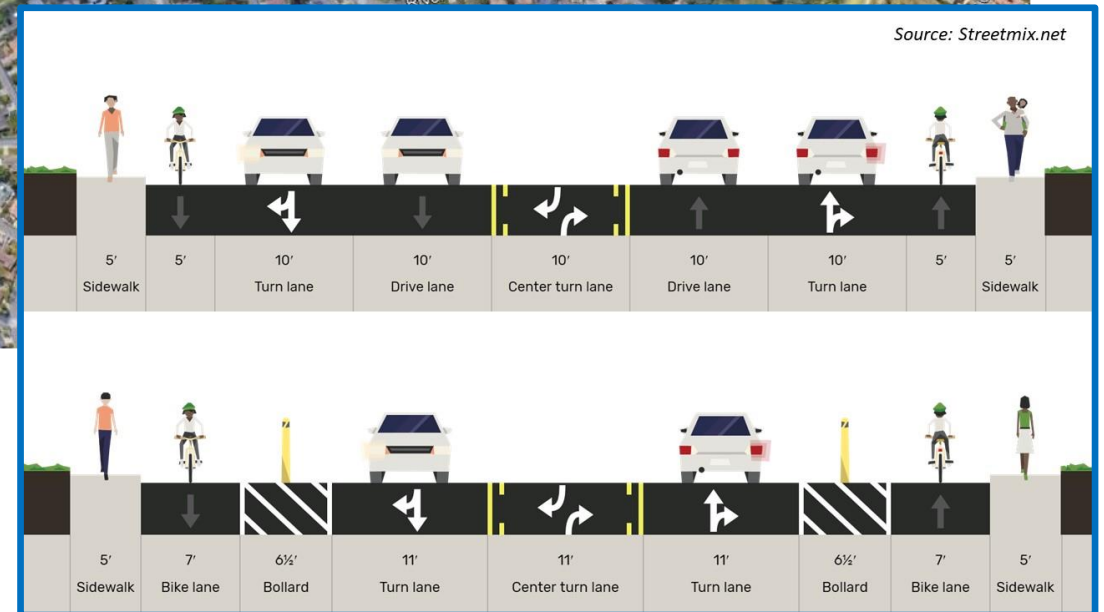

East Bidwell Street Bicycle/Pedestrian Undercrossing



Santa Juanita Avenue Realignment Study



2022/23 Funding Round Priorities



Project Name (initial priority)	Category	Requested	Description
(1) US50/Empire Ranch Interchange [10]	Transformative	\$10M	Phase 1 Construction
(2) Natoma Street Drainage [4]	M&M	\$200k	Design
(3) Folsom-Placerville Rail Trail [2]	M&M	\$1.7M	Construction
(4) Oak Ave Complete Streets [6]	M&M	\$655k	Design/Enviro
(5) Pavement Repair & Rehabilitation [3]	M&M	\$1M	Maintenance
(6) Amer. River Canyon Dr Road Diet	M&M	\$2.66M	Design/Construction
(7) US50/E. Bidwell Trail Undercrossing	M&M (new)	\$3M	Design/Construction
(8) Santa Juanita Ave Curve [7]	M&M (new)	\$250k	Planning/Environmental
(9) RAB Policy Planning Study [5]	Community Design (new)	\$100k-\$200K	Planning
(10) Trail Maintenance [1]	M&M (new)	\$2.0M	Maintenance