

IMPROVEMENT PLANS FOR

# FOLSOM ZOO SANCTUARY

## FENCE RETROFIT

### FOLSOM, CALIFORNIA

APN: 071-0010-014

#### GENERAL NOTES

1. LOCAL CODES AND ORDINANCES: WORK SHALL CONFORM TO ALL LOCAL CODES, ORDINANCES, AND REQUIREMENTS, INCLUDING FEDERAL ACCESSIBILITY GUIDELINES. NOTHING IN THE CONTRACT DOCUMENTS SHALL BE CONSTRUED AS AN EXEMPTION TO APPLICABLE CODES OR OTHER JURISDICTIONAL REQUIREMENTS.
2. UNAUTHORIZED CHANGES AND USES: ROACH & CAMPBELL WILL NOT BE RESPONSIBLE FOR, OR LIABLE FOR, UNAUTHORIZED CHANGES TO OR USES OF THESE PLANS. ALL CHANGES TO THE PLANS MUST BE IN WRITING AND MUST BE APPROVED BY ROACH & CAMPBELL.
3. JOB SITE CONDITIONS: THE CONTRACTOR AGREES THAT IN ACCORDANCE WITH GENERALLY ACCEPTED CONSTRUCTION PRACTICES THAT THE CONTRACTOR WILL BE REQUIRED TO ASSUME SOLE AND COMPLETE RESPONSIBILITY FOR JOB SITE CONDITIONS DURING THE COURSE OF CONSTRUCTION OF THE PROJECT, INCLUDING SAFETY OF ALL PERSONS AND PROPERTY; THAT THIS REQUIREMENT SHALL BE MADE TO APPLY CONTINUOUSLY AND NOT BE LIMITED TO NORMAL WORKING HOURS.
4. SCHEDULE: ZOO WILL REMAIN OPEN TO THE PUBLIC DURING WORK. A TEMPORARY ENTRANCE WILL BE SET UP FOR VISITORS DURING WORK ON THE MAIN ENTRANCE. CONTRACTOR SHALL PROVIDE OWNER A DETAILED SCHEDULE OF WORK PRIOR TO BEGINNING OF WORK. SCHEDULE SHALL INCLUDE WHEN EACH FENCE SEGMENT IS BEING WORKED ON; HOW LONG THAT WORK IS EXPECTED TO TAKE; AND WHEN WORK WILL OCCUR NEAR THE MAIN ENTRANCE. CONTRACTOR SHALL PROVIDE AN UPDATE WHENEVER THE SCHEDULE CHANGES.
5. UTILITIES: CONTACT UNDERGROUND SERVICE ALERT (U.S.A.) AT 811, AT LEAST TWO WORKING DAYS IN ADVANCE OF EXCAVATION WORK (PER CA GOV. CODE 4216). THE CONTRACTOR SHALL PROTECT ALL EXISTING UTILITIES, WHETHER SHOWN OR NOT, AND SHALL PAY FOR ANY REPAIRS REQUIRED DUE TO THE CONTRACTOR'S OPERATIONS AT NO ADDITIONAL EXPENSE TO THE OWNER.
6. DISCREPANCIES: NOTIFY OWNER'S REPRESENTATIVE OF ANY VARIATIONS BETWEEN THE CONTRACT DOCUMENTS AND FIELD CONDITIONS. DO NOT PROCEED WHERE DIFFERENCES EXIST THAT WOULD AFFECT THE WORK. ALL ADJUSTMENTS DUE TO FIELD CONDITIONS MUST BE APPROVED BY THE DISTRICT'S REPRESENTATIVE PRIOR TO CONTINUING.
7. COORDINATION: CONTRACTOR SHALL COORDINATE WORK BETWEEN TRADES. ALL REQUIRED SLEEVING SHALL BE COORDINATED WITH SITE WORK, INCLUDING OTHER UNDERGROUND UTILITIES, CURBS, AND CONCRETE.
8. LEAD TIME: SPECIFIED MATERIALS MAY REQUIRE A SIGNIFICANT LEAD TIME. CONTRACTOR IS SOLELY RESPONSIBLE TO LEAD TIMES AND TO PROVIDE SUBMITTALS, AND ORDER MATERIAL, AND ENSURE DELIVERY TO THE JOB SITE TO ALLOW TIMELY PROGRESSION OF WORK.
9. SUBSTITUTIONS: IF PROPOSED, SHALL BE SUBMITTED IN WRITING BY THE CONTRACTOR TO THE OWNER AND LANDSCAPE ARCHITECT, AND SHALL DEMONSTRATE HOW MATERIAL IS EQUAL OR BETTER TO ORIGINALLY SPECIFIED MATERIALS. ANY SUBSTITUTIONS NOT APPROVED IN WRITING ARE SUBJECT TO REJECTION.
10. EXISTING WORK: WHERE NEW CONSTRUCTION ABUTS EXISTING WORK, ALL EXISTING WORK SHALL BE PROTECTED. CONTRACTOR SHALL REPLACE ANY DAMAGED EXISTING WORK AT NO ADDITIONAL EXPENSE TO THE OWNER. ALL NEW WORK WILL CONFORM TO TO EXISTING WORK, INCLUDING FLATWORK JOINTS, ELEVATIONS, COLOR, AND FINISH.
11. SURVEY MONUMENTS: THE CONTRACTOR SHALL BE RESPONSIBLE FOR THE PROTECTION OF ALL EXISTING SURVEY MONUMENTS AND OTHER SURVEY MARKERS DURING CONSTRUCTION. ALL SUCH MONUMENTS OR MARKERS DESTROYED DURING CONSTRUCTION SHALL BE REPLACED AT THE CONTRACTOR'S EXPENSE.
12. SPECIFICATIONS: CITY OF FOLSOM STANDARD SPECIFICATIONS ARE INTEGRAL TO THE CONTRACT DOCUMENTS. IF A CONFLICT BETWEEN THE PLANS AND SPECIFICATIONS OCCURS, THE MORE STRINGENT REQUIREMENT SHALL APPLY.
13. EMISSIONS: THE CONTRACTOR SHALL COMPLY WITH ALL LOCAL REGULATIONS FOR CONTROLLING EMISSIONS. THE CONTRACTOR SHALL MAINTAIN AND OPERATE CONSTRUCTION EQUIPMENT TO MINIMIZE EXHAUST EMISSIONS. DURING CONSTRUCTION, TRUCKS AND EQUIPMENT SHALL BE OPERATED ONLY WHEN NECESSARY AND ENGINES SHALL BE SHUT OFF WHEN TRUCKS ARE BEING LOADED OR UNLOADED OR OTHERWISE STATIONARY. EQUIPMENT SHALL BE MAINTAINED IN GOOD CONDITION AND WELL-TUNED TO MINIMIZE EXHAUST EMISSIONS.
14. WATER EFFICIENT LANDSCAPE ORDINANCE: THIS PROJECT REHABILITATES LESS THAN 1,000 SQUARE FEET OF LANDSCAPE, RENDERING IT EXEMPT FROM THE MODEL WATER EFFICIENT LANDSCAPE ORDINANCE REQUIREMENTS.

#### SECURITY NOTES

1. SECURITY REQUIREMENTS: FOLSOM ZOO SANCTUARY MUST REMAIN FULLY ENCLOSED AT ALL TIMES THROUGHOUT CONSTRUCTION.
2. RETAIN EXISTING FENCE: WHERE POSSIBLE, RETAIN EXISTING FENCE UNTIL NEW FENCE IS INSTALLED.
3. TEMPORARY FENCING DURING WORK HOURS: WHERE DEMOLITION OF PART OR ALL OF EXISTING FENCE IS REQUIRED PRIOR TO INSTALLATION OF PROPOSED FENCE, CONTRACTOR SHALL INSTALL TEMPORARY MIN 6' HIGH CHAIN LINK SECURITY FENCING DURING TIMES OF ACTIVE WORK TO PREVENT ACCESS BY PEOPLE AND/OR PREDATOR ANIMALS.
4. TEMPORARY FENCING OUTSIDE OF ACTIVE WORK HOURS: CONTRACTOR SHALL INSTALL NEW FENCE SEGMENTS SUCH THAT THE ZOO PERIMETER IS FULLY SECURE AT THE END OF EACH DAY OF WORK. SECURE IS DEFINED AS A SEVEN FOOT TALL CHAIN LINK FENCE WITH ONE FOOT OF BARBED WIRE OR AN EIGHT FOOT TALL NON-CLIMBABLE SOLID FENCE THAT IS PERMANENTLY INSTALLED OR LOCKED TO THE EXISTING FENCE AT CONSTRUCTION LIMITS WITH NO GAPS OVER 3.75" IN ANY DIRECTION.

#### APPLICABLE CODES

2022 CALIFORNIA BUILDING CODE  
2022 CALIFORNIA FIRE CODE  
2022 CALIFORNIA ELECTRICAL CODE  
2022 CALIFORNIA PLUMBING CODE  
2022 CALIFORNIA GREEN (CALGREEN) BUILDING STANDARDS CODE  
2023 CITY OF FOLSOM MUNICIPAL CODE  
2020 CITY OF FOLSOM CONSTRUCTION SPECIFICATIONS AND CONSTRUCTION DETAILS

#### SHEET INDEX

|           |                          |
|-----------|--------------------------|
| L0.1      | COVER SHEET              |
| L1.0      | FENCING NOTES AND LEGEND |
| L1.1-L1.2 | FENCING DIAGRAM          |
| L1.3-L1.4 | LAYOUT ENLARGEMENTS      |
| L2.1-L2.3 | CONSTRUCTION DETAILS     |

#### KEY MAP

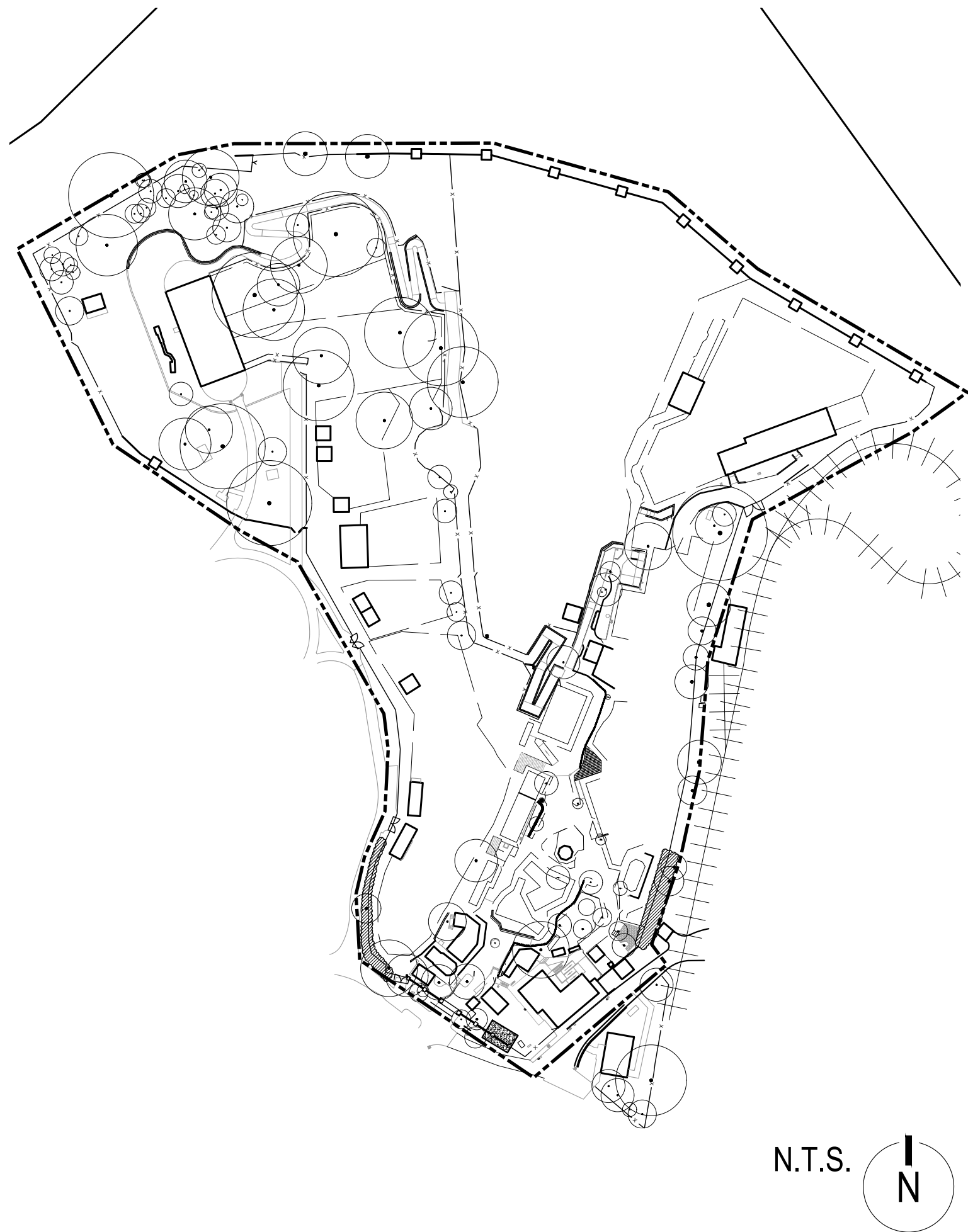

#### VICINITY MAP

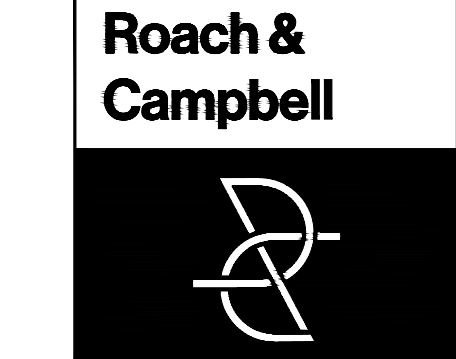
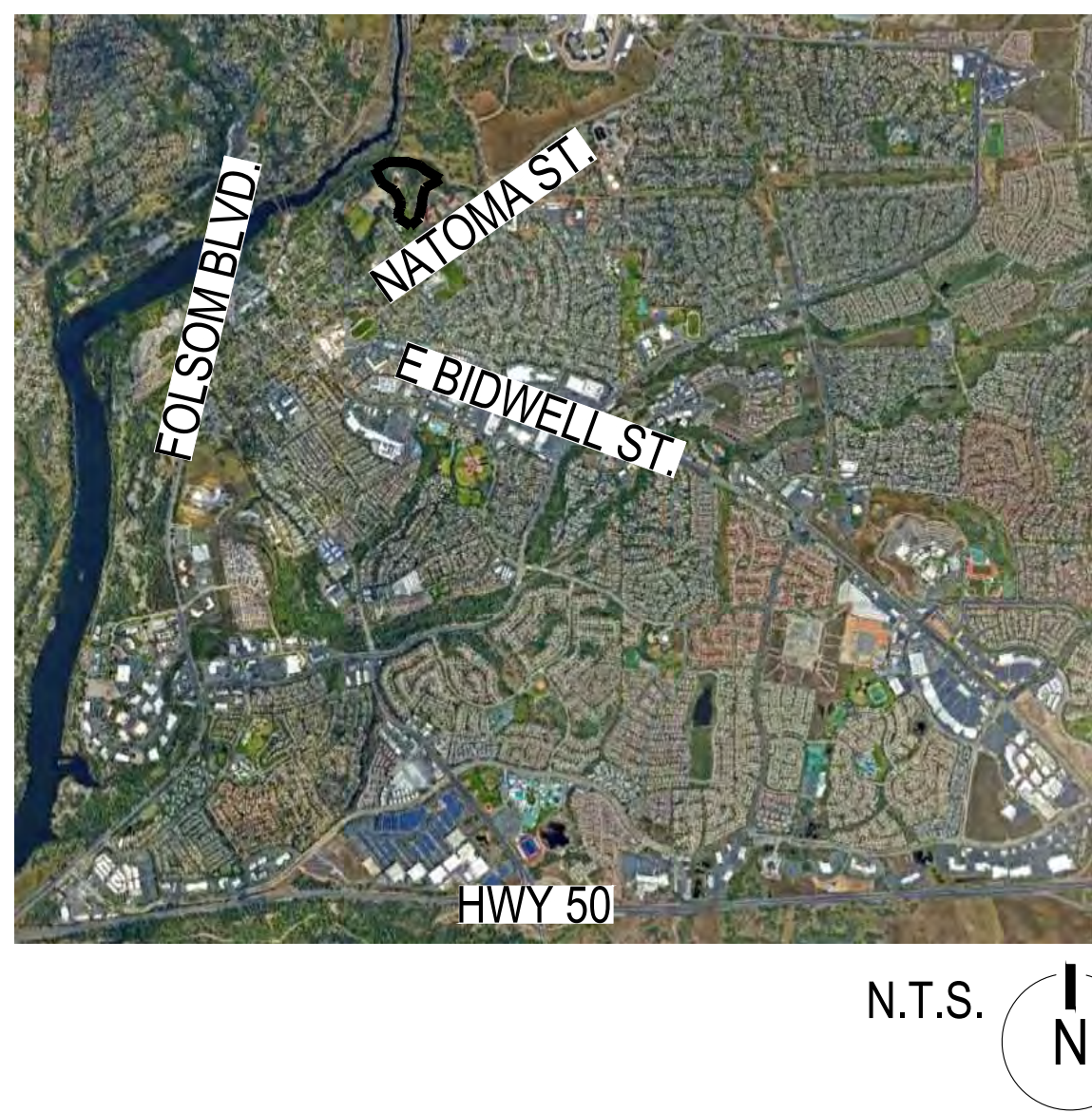

111 Scripps Drive  
Sacramento,  
California 95825  
916.945.8003 | 916.342.7119  
4409 CRLA 5044

#### FENCE RETROFIT FOR

### FOLSOM ZOO SANCTUARY

#### BY CITY OF FOLSOM

KEYMAP:

#### COVER

DRAWN BY:

JLL

CHECKED BY:

WMB

JOB NO.

23014

DATE

MAY 18, 2023

REVISIONS:

|  |
|--|
|  |
|  |
|  |
|  |
|  |



# L0.1

DRAWINGS IN SET:

FIRST SUBMITTAL - NOT FOR CONSTRUCTION



CONSTRUCTION NOTES

1. LAYOUT NOTES: THE WRITTEN DIMENSION SUPERCEDES SCALED OR GRAPHIC DENOTATION. DIMENSIONS ARE BETWEEN PARALLEL OR PERPENDICULAR POINTS UNLESS NOTED OTHERWISE. DIMENSIONS ARE TO CENTERLINE OR FACE OF MASONRY, CONCRETE, OR FRAMING SUBSTRATE FINISH SURFACES, UNLESS NOTED OTHERWISE.
2. VERTICAL WORK: ALL VERTICAL CONSTRUCTION SHALL BE INSTALLED TRUE AND PLUMB. ALL UNIT COURSING AND TOPS OF WALLS, FENCES, ETC. SHALL BE LEVEL UNLESS NOTED OTHERWISE. ALL CURVES SHALL BE CONTINUOUS AND EVEN, WITH NO BREAKS OR ANGLES AT POINTS OF TANGENCY OR FORMWORK JOINTING.
3. CLEAR AND GRUB: REMOVE ALL VINES, SHRUBS, AND TREES WITH TRUNKS UNDER 6" DBH WITHIN THREE FEET OF PROPOSED FENCE LOCATIONS.
4. PRUNING: PRUNE TREES SO THAT ANY BRANCHES OVER 1" IN DIAMETER ARE A MINIMUM THREE FEET CLEAR, HORIZONTALLY AND VERTICALLY OF THE PROPOSED FENCE LOCATION AND IF REQUIRED TO PREVENT DAMAGE DURING CONSTRUCTION, CONTRACTOR SHALL MARK ALL LIMBS TO BE PRUNED FOR APPROVAL BY CLIENT AND LANDSCAPE ARCHITECT PRIOR TO PRUNING.
5. TREE PROTECTION: ALL TREES OVER 3" DBH SHALL BE PROTECTED IN PLACE UNLESS NOTED FOR REMOVAL ON PLANS. THE INTENT OF THESE PLANS IS THAT NO TREE TRUNKS SHALL BE WITHIN 3' OF THE PERIMETER FENCE; IF TREES ARE WITHIN THREE FEET OF PROPOSED FENCE LOCATIONS, NOTIFY CITY REPRESENTATIVE AND LANDSCAPE ARCHITECT IN WRITING IMMEDIATELY. CONTRACTOR SHALL MARK ALL TREES TO BE REMOVED FOR APPROVAL BY CLIENT AND LANDSCAPE ARCHITECT PRIOR TO REMOVAL.
6. TREE PROTECTION ZONE (TPZ): MINIMUM TPZ IS DRIPLINE RADIUS +1 FOOT.
7. RESTRICTIONS WITHIN TPZ: NO PARKING, PORTABLE TOILETS, DUMPING OR STORAGE OF ANY CONSTRUCTION MATERIALS ARE ALLOWED IN THE TPZ; NO SIGNS, ROPES, CABLES, OR ANY OTHER ITEM SHALL BE ATTACHED TO A PROTECTED TREE, UNLESS RECOMMENDED BY A CITY-APPROVED ARBORIST.

FENCE AND GATE LEGEND

- FENCE SEGMENT
- GATE. # REFERS TO WHICH FENCE SEGMENT GATE IS ADJACENT TO, X SEQUENTIALLY LETTERS EACH GATE IN SEGMENT
- GREY SYMBOLS INDICATE SEGMENTS THAT REQUIRE NO CHANGE

PERIMETER FENCE AND GATE SEGMENTS

FENCE AND GATE TABLE SEGMENTS REFER TO FENCE DIAGRAM, SHEET L1.1 AND L1.2.  
Folsom Zoo Sanctuary  
Fence and Gate Table

23014  
5/18/2023

| Fence and Gate Segment | Approximate Length (feet) | Existing Condition  | Proposed Condition - Base Bid   | Privacy Screen?   | Details  | Add Alts   |
|------------------------|---------------------------|---|---|---|--|--|
|                        | 416                       | 2" chain-link with slats and barbed wire top.                               | Remove existing fence and relocate fence per enlargement. New fence shall be 7' tall 1" chain link + 1' barbed wire top.              | Yes, full height.<br>Color: Dark Green                              | Enlargement: 2/L1.3<br>Fence: 1/L2.1   | N/A  |
|                        | 12                        | (2) 6' swinging chain-link gates.   | Remove existing gate. Install new gate where shown on enlargement with (2) 6' wide swinging 1" chain-link gates + 1' barbed wire top. | Yes, full height.<br>Color: Dark Green                              | Enlargement: 2/L1.3<br>Gate: 2/L2.1  | N/A  |
|                        | 12                        | (2) 6' swinging chain-link gates.   | Remove existing gate. Install new gate where shown on enlargement with (2) 6' wide swinging 1" chain-link gates + 1' barbed wire top. | Yes, full height.<br>Color: Dark Green                              | Enlargement: 2/L1.3<br>Gate: 2/L2.1  | N/A  |
|                        | 178                       | 8' tall black tubular steel fence with spear tips.                          | Protect fence in place.   | Yes, 4' privacy screen at bottom of existing fence.<br>Color: Black | Privacy screen to match privacy screen on detail 1/L2.1. Install with tamperproof method per manufacturer's recommendations. | N/A  |
|                        | 12                        | (2) 6' wide, 8' tall swinging tubular steel gates.                          | Protect gate in place.  | Yes, 4' privacy screen at bottom of existing fence.<br>Color: Black | Privacy screen to match privacy screen on detail 1/L2.1. Install with tamperproof method per manufacturer's recommendations. | N/A  |
|                        | 14                        | Secondary Entrance Metal Gate   | Protect gate in place.  | Yes, 4' privacy screen at bottom of existing fence.<br>Color: Black | Privacy screen to match privacy screen on detail 1/L2.1. Install with tamperproof method per manufacturer's recommendations. | N/A  |
|                        | 390                       | 7' tall 1" chain-link with + 1' barbed wire top.                            | No change.  | No change.  | N/A  | N/A  |
|                        | 12                        | (2) 6' wide, 7' tall 1" chain-link gates + 1' barbed wire.                  | No change.  | No change.  | N/A  | N/A  |
|                        | 12                        | (2) 6' wide, 7' tall 1" chain-link gates + 1' barbed wire.                  | No change.  | No change.  | N/A  | N/A  |
|                        | 15                        | 6.5' tall 2" chain-link with + 1' barbed wire top.                          | Remove and replace fence. Location to remain the same. New fence shall be 7' tall 1" chain link + 1' barbed wire top.                 | No.   | 1/L2.1   | N/A  |
|                        | 89                        | 7' tall 2" chain-link with +1' barbed wire top and privacy slats.           | No change.  | No change.  | N/A  | Retain posts, replace chain link with 7' tall 1" chain link and privacy screen + 1' barbed wire per 1/L1.2 |
|                        | 360                       | 6.5' tall 2" chain-link with + 1' barbed wire top and privacy slats.        | Remove and replace fence. Location to remain the same. New fence shall be 7' tall 1" chain link + 1' barbed wire top.                 | No.   | 1/L2.1   | N/A  |
|                        | 180                       | 7' tall 2" chain-link with +1' barbed wire top and privacy slats.           | Protect fence in place. Remove barbed wire top and replace with new 1' tall barbed wire top.  | No change.  | 4/L2.1   | Retain posts, replace chain link with 7' tall 1" chain link and privacy screen + 1' barbed wire per 1/L1.2 |
|                        | 3.5                       | 8' tall 2" chain-link pedestrian gate                                       | Protect gate in place. Add 2" welded wire mesh panel along bottom of gate to prevent gaps over 4".                                    | No change.  | 1/L2.2   | N/A  |
|                        | 12                        | (2) 6' wide, 7' tall 2" chain-link gates + 1' barbed wire.                  | Protect gate in place. Add 2" welded wire mesh panel along bottom of gate and side of gate to prevent gaps over 4".                   | No change.  | 1/L2.2   | N/A  |
|                        | 198                       | 7' tall 2" chain-link with +1' barbed wire top and privacy slats.           | No change.  | No change.  | N/A  | Retain posts, replace chain link with 7' tall 1" chain link and privacy screen + 1' barbed wire per 1/L1.2 |
|                        | 16                        | (2) 8' wide, 7' tall 2" chain-link gates + 1' barbed wire.                  | Remove and replace existing gate with (2) 8' wide, 7' tall swinging 1" chain-link gates + 1' barbed wire top.                         | Yes, full height.<br>Color: Dark Green                              | 2/L2.1   | N/A  |
|                        | 383                       | 6.5' tall 2" chain-link with + 1' barbed wire top and privacy slats.        | Remove existing fence and relocate fence per enlargement. New fence shall be 7' tall 1" chain link + 1' barbed wire top.              | Yes, full height.<br>Color: Dark Green                              | Enlargement: 1/L1.4<br>Fence: 1/L2.1   | N/A  |
|                        | 45                        | 6.5' tall 2" chain-link with + 1' barbed wire top and privacy slats.        | Remove and replace fence. Location to remain the same. New fence shall be 7' tall 1" chain link + 1' barbed wire top.                 | Yes, full height.<br>Color: Dark Green                              | 1/L2.1   | N/A  |
|                        | 9                         | 6.5' tall 2" chain-link with + 1' barbed wire top and privacy slats.        | Remove and replace fence. Location to remain the same. New fence shall be 8.5' tall 1" chain link + 1' barbed wire top.               | Yes, full height.<br>Color: Dark Green                              | 3/L2.1   | N/A  |
|                        | 52                        | 8' tall black tubular steel fence with spear tips and steel privacy panels. | No change.  | No change.  | N/A  |  |
|                        | 3.5                       | 8' tall black tubular steel ada access gate.                                | No change.  | No change.  | N/A  | N/A  |
|                        | 10                        | (2) 5' wide, 8' tall swinging tubular steel gates.                          | No change.  | No change.  | N/A  | N/A  |
|                        | 47                        | 6' tall wood fence with stone columns.                                      | Remove fence and columns per enlargement. Add new 8' tall black tubular steel fence.  | Install solid metal backing on fence.<br>Color: Black               | Enlargement: 1/L1.3<br>Fence: 3/L2.2   | N/A  |
|                        | 47                        | 6' tall wood fence with stone columns.                                      | Protect existing fence in place. Add new 8' tall black tubular steel fence.   | Yes, 4' privacy screen at bottom of fence.                          | Enlargement: 1/L1.3<br>Fence: 3/L2.2   | N/A  |
|                        | 22                        | Main entrance.  | Add cantilevered security gate. Replace wood pergola on main entrance with metal.   | Yes, 4' privacy screen at bottom of security gate.<br>Color: Black  | Enlargement: 1/L1.3<br>Security Gate: 4/L2.2<br>Pergola: 1/L2.3  | N/A  |
|                        | 12                        | (2) 6' swinging chain-link gates.   | Remove existing gate. Install new gate where shown on enlargement with (2) 6' wide swinging metal gates.                              | Yes, 4' privacy screen at bottom of gate.<br>Color: Black           | Enlargement: 1/L1.3<br>Metal swing gate: 2/L2.2  | N/A  |

Roach & Campbell



111 Scripps Drive  
Sacramento,  
California 95825  
916.945.8003 | 916.342.7119  
4409 CRLA 5044

FENCE  
RETROFIT  
FOR

FOLSOM  
ZOO  
SANCTUARY

BY CITY OF  
FOLSOM

KEYMAP:

FENCING NOTES AND  
LEGEND

DRAWN BY:

JLL

CHECKED BY:

WMB

JOB NO.

23014

DATE

MAY 18, 2023

REVISIONS:

L1.0

DRAWINGS IN SET:

9

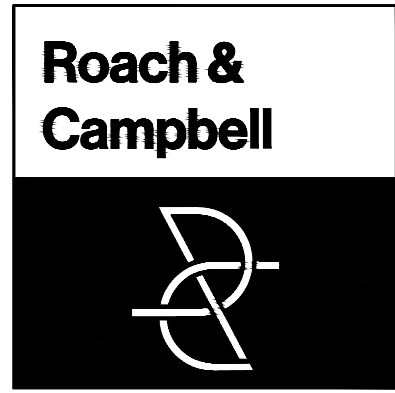
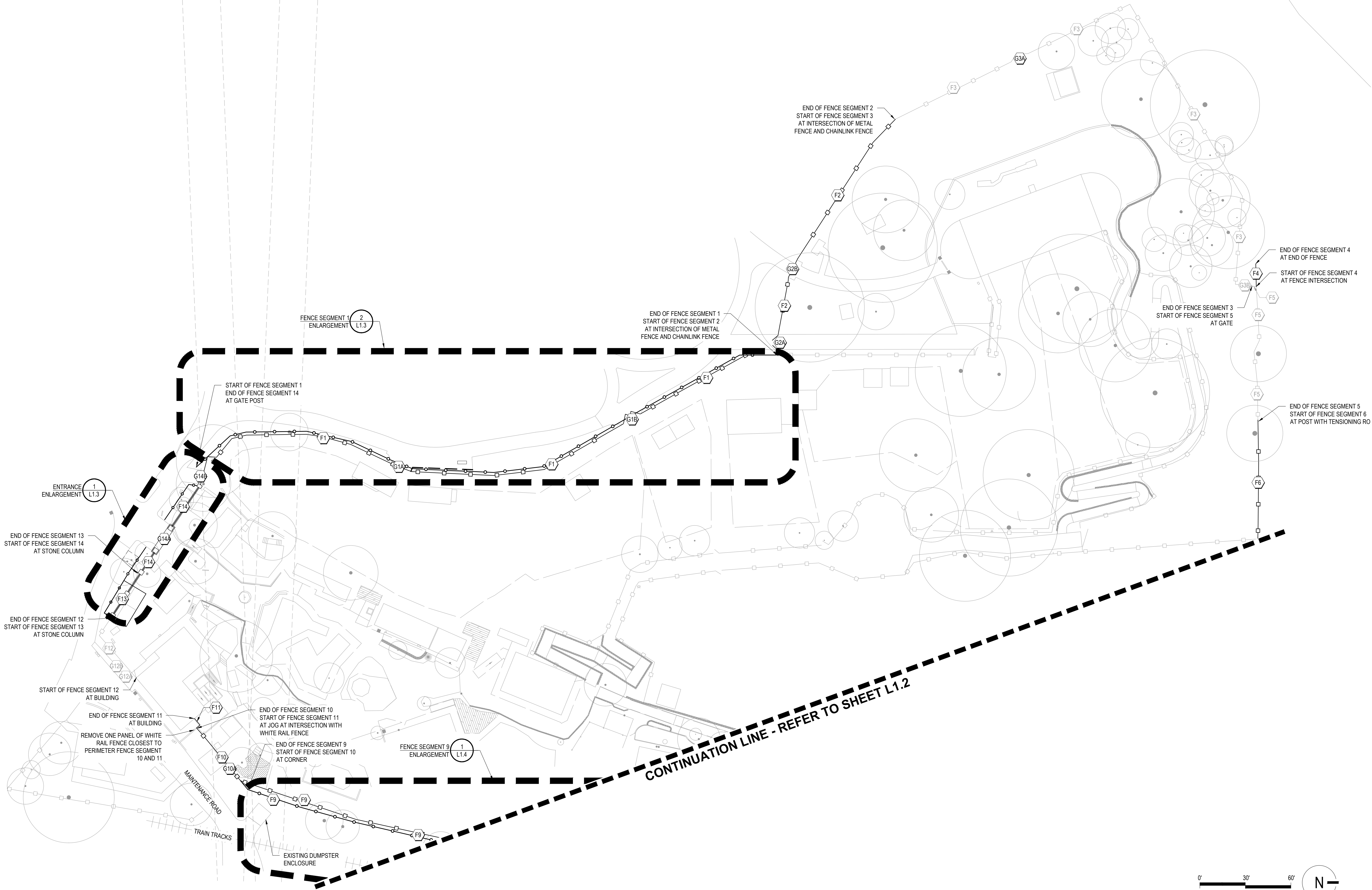

111 Scripps Drive  
Sacramento,  
California 95825  
916.945.8003 | 916.342.7119  
4409 CRLA 5044

## FENCE RETROFIT FOR

## FOLSOM ZOO SANCTUARY

### BY CITY OF FOLSOM

KEYMAP:

### FENCE DIAGRAM

DRAWN BY:  
JLL  
CHECKED BY:  
WMB  
JOB NO.  
23014  
DATE  
MAY 18, 2023  
REVISIONS:

\_\_\_\_\_  
\_\_\_\_\_  
\_\_\_\_\_  
\_\_\_\_\_

\_\_\_\_\_  
\_\_\_\_\_

# L1.1

DRAWINGS IN SET: 9

FIRST SUBMITTAL - NOT FOR CONSTRUCTION

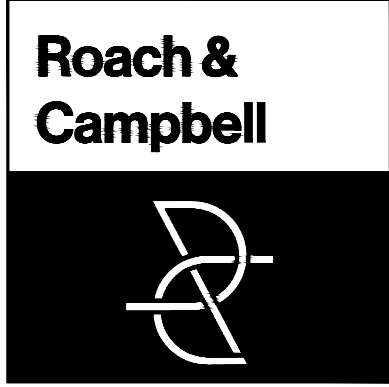
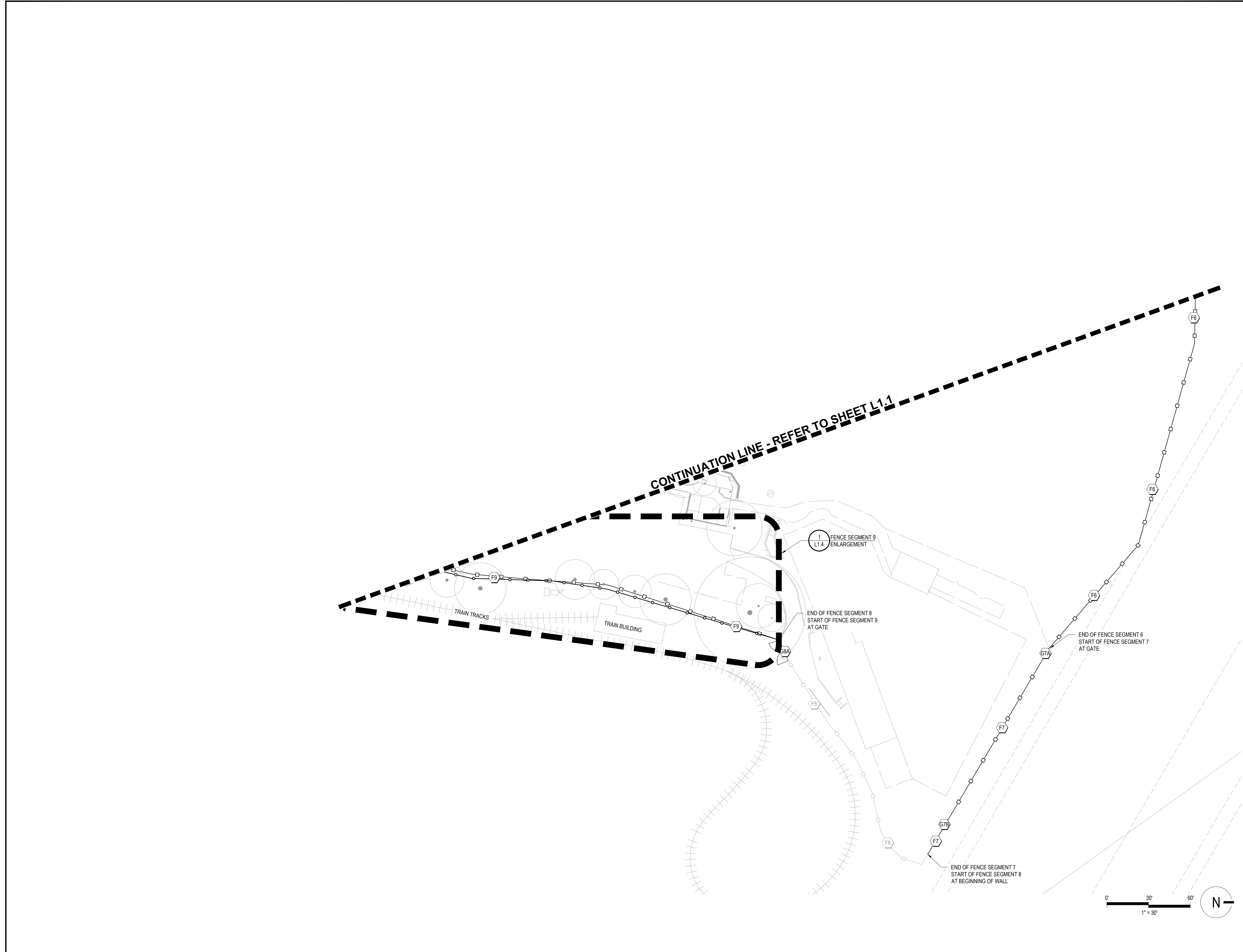

111 Scripps Drive  
Sacramento,  
California 95825  
916.945.8003 | 916.342.7119  
4409 CRLA 5044

FENCE  
RETROFIT  
FOR  
  
FOLSOM  
ZOO  
SANCTUARY

BY CITY OF  
FOLSOM

KEYMAP:

FENCE DIAGRAM

DRAWN BY:

JLL

CHECKED BY:

WMB

JOB NO.

23014

DATE

MAY 18, 2023

REVISIONS:

DRAWINGS IN SET:

L1.2

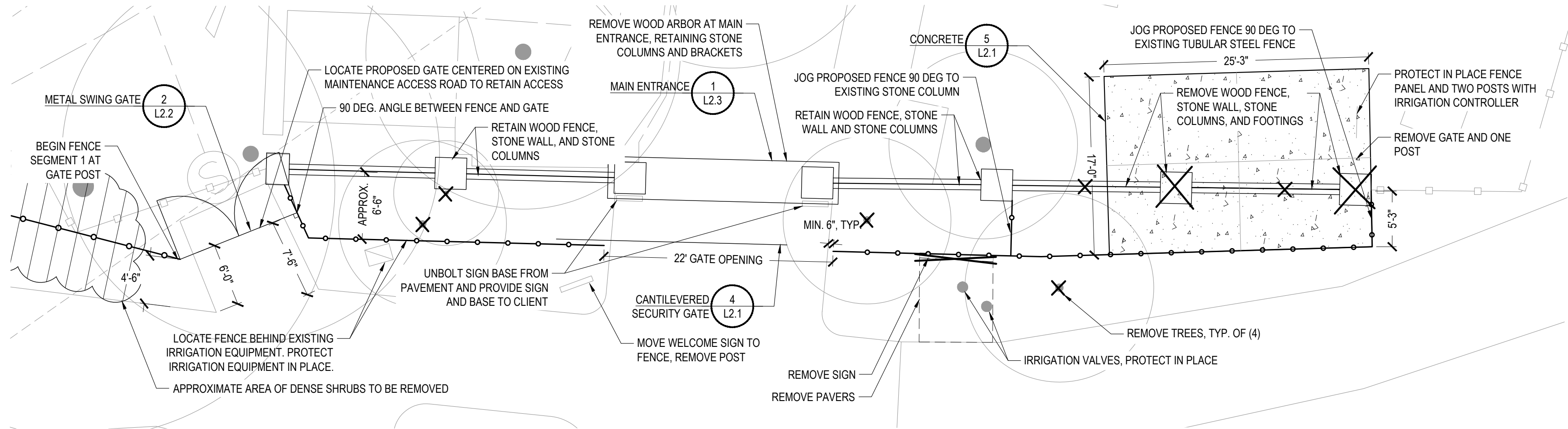

NOTES:  
1. CONTRACTOR SHALL STAKE ALIGNMENT OF FENCES, GATES, AND CONCRETE FOR APPROVAL BY CLIENT AND LANDSCAPE ARCHITECT PRIOR TO INSTALLATION.

## 1 | ENTRANCE

1/8" = 1'-0"

ENLARGEMENT

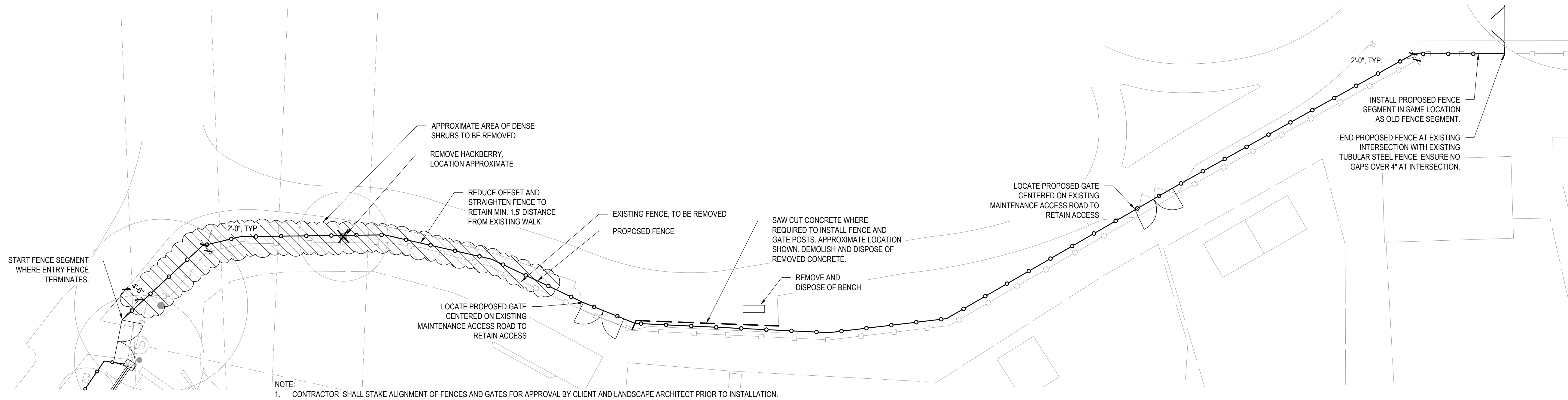

NOTE:  
1. CONTRACTOR SHALL STAKE ALIGNMENT OF FENCES AND GATES FOR APPROVAL BY CLIENT AND LANDSCAPE ARCHITECT PRIOR TO INSTALLATION.

## 2 | FENCE SEGMENT 1

1/16" = 1'-0"

ENLARGEMENT

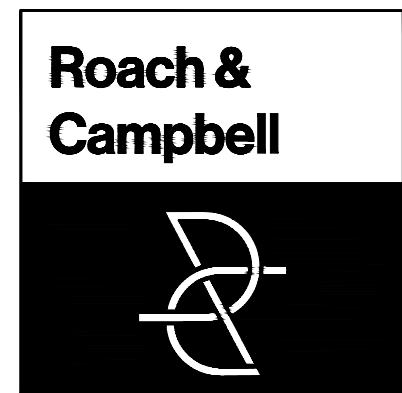

111 Scripps Drive  
Sacramento,  
California 95825  
916.945.8003 | 916.342.7119  
4409 CRLA 5044

## FENCE RETROFIT FOR

## FOLSOM ZOO SANCTUARY

### BY CITY OF FOLSOM

KEYMAP:

### LAYOUT ENLARGEMENTS

DRAWN BY:

JLL

CHECKED BY:

WMB

JOB NO.

23014

DATE

MAY 18, 2023

REVISIONS:

DRAWINGS IN SET:

9

# L1.3

FIRST SUBMITTAL - NOT FOR CONSTRUCTION



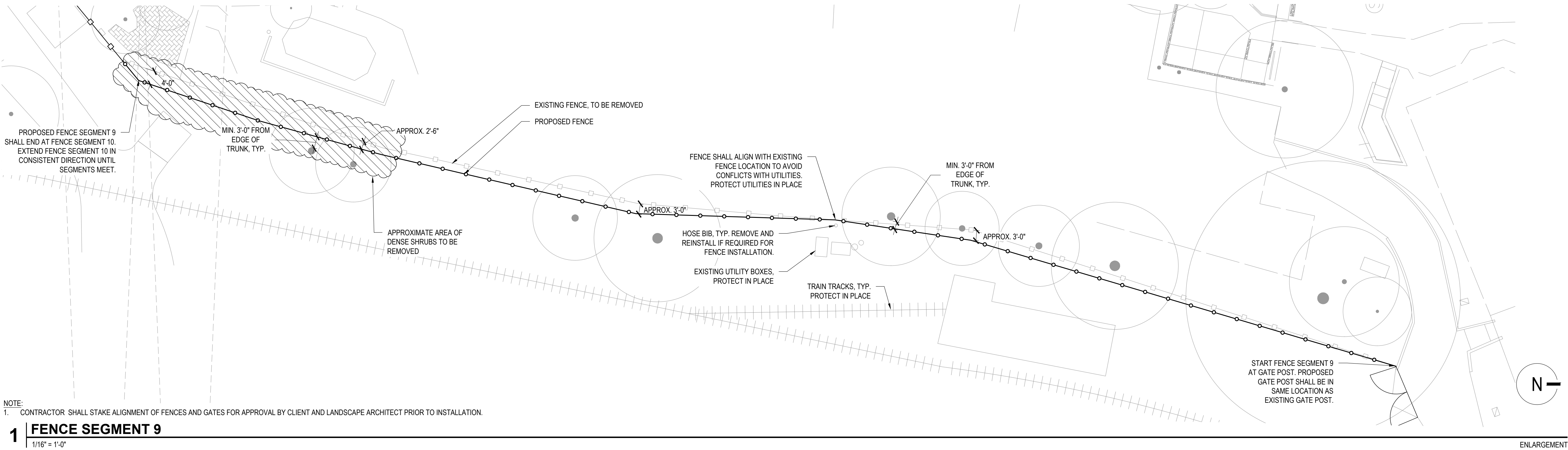

NOTE:  
1. CONTRACTOR SHALL STAKE ALIGNMENT OF FENCES AND GATES FOR APPROVAL BY CLIENT AND LANDSCAPE ARCHITECT PRIOR TO INSTALLATION.

## 1 FENCE SEGMENT 9

1/16" = 1'-0"

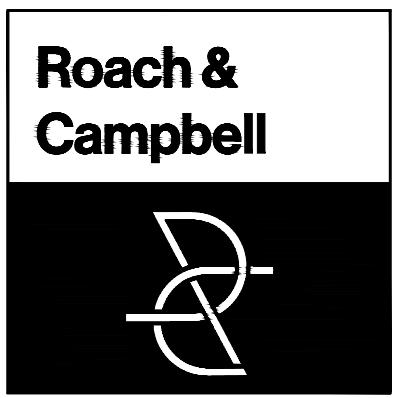

111 Scripps Drive  
Sacramento,  
California 95825  
916.945.8003 | 916.342.7119  
4409 CRLA 5044

## FENCE RETROFIT FOR

## FOLSOM ZOO SANCTUARY

### BY CITY OF FOLSOM

KEYMAP:

### CONSTRUCTION DETAILS

DRAWN BY:

JLL

CHECKED BY:

WMB

JOB NO.

23014

DATE

MAY 18, 2023

REVISIONS:

|  |
|--|
|  |
|  |
|  |
|  |
|  |

# L1.4

DRAWINGS IN SET:

9

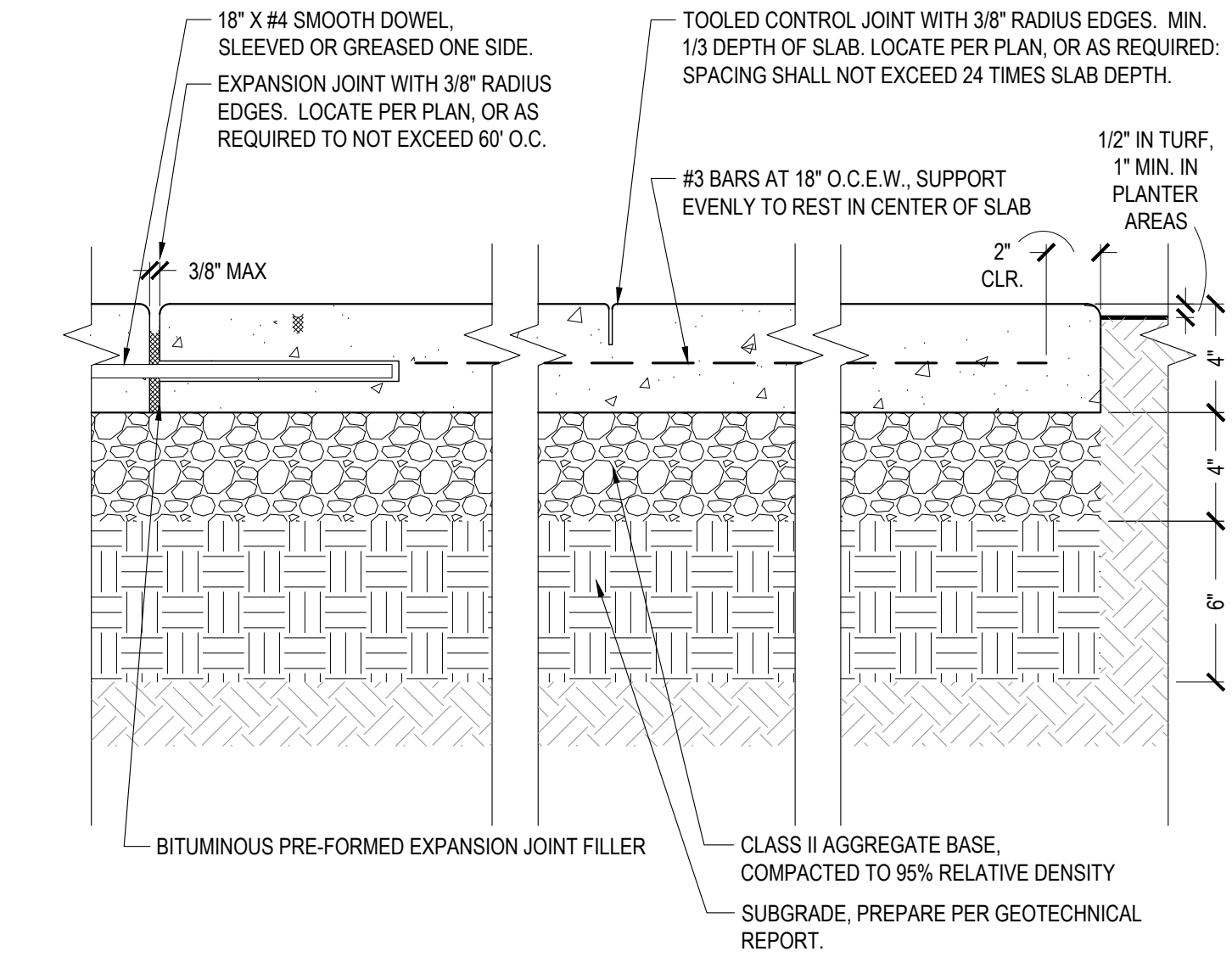
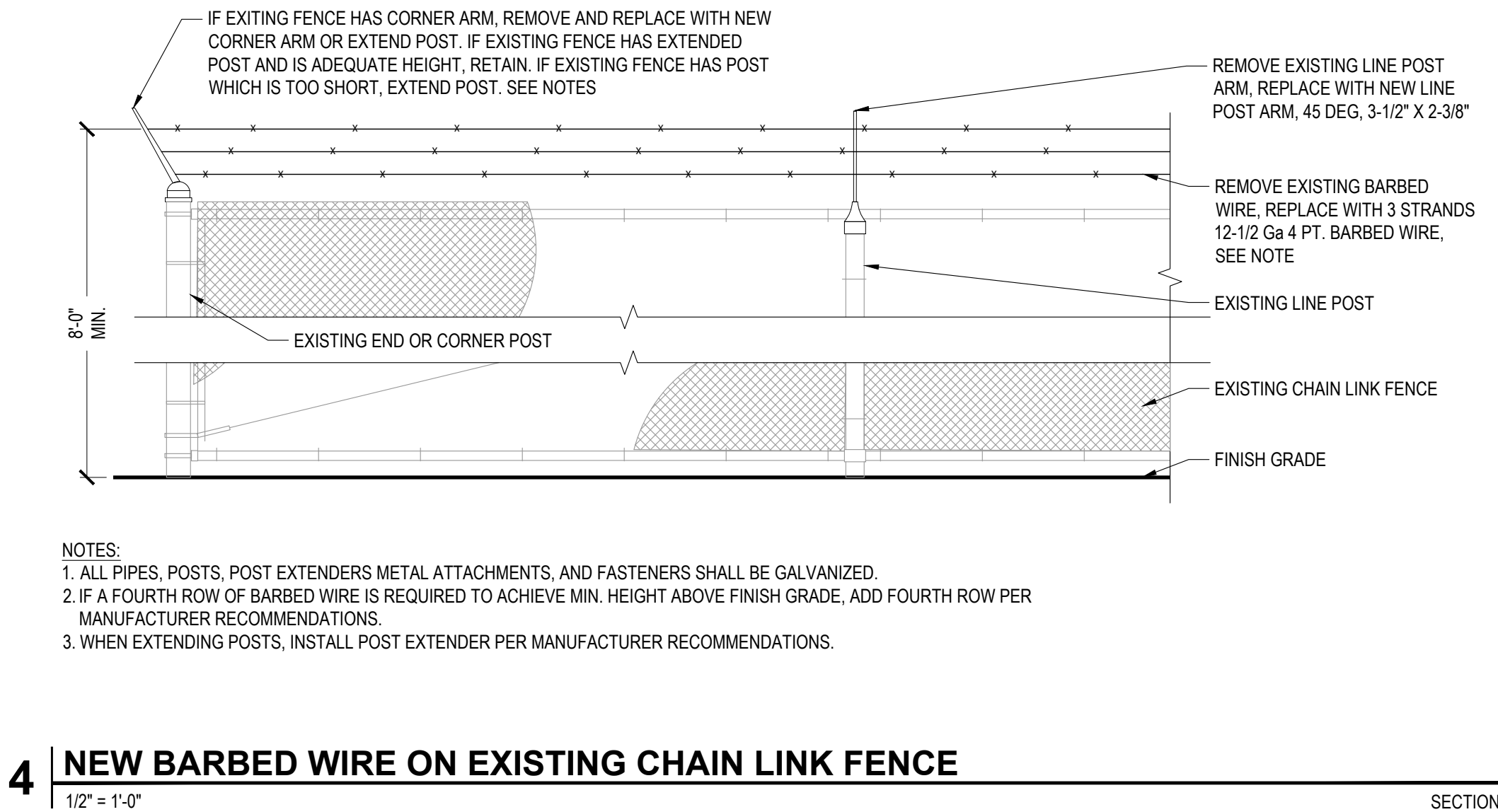
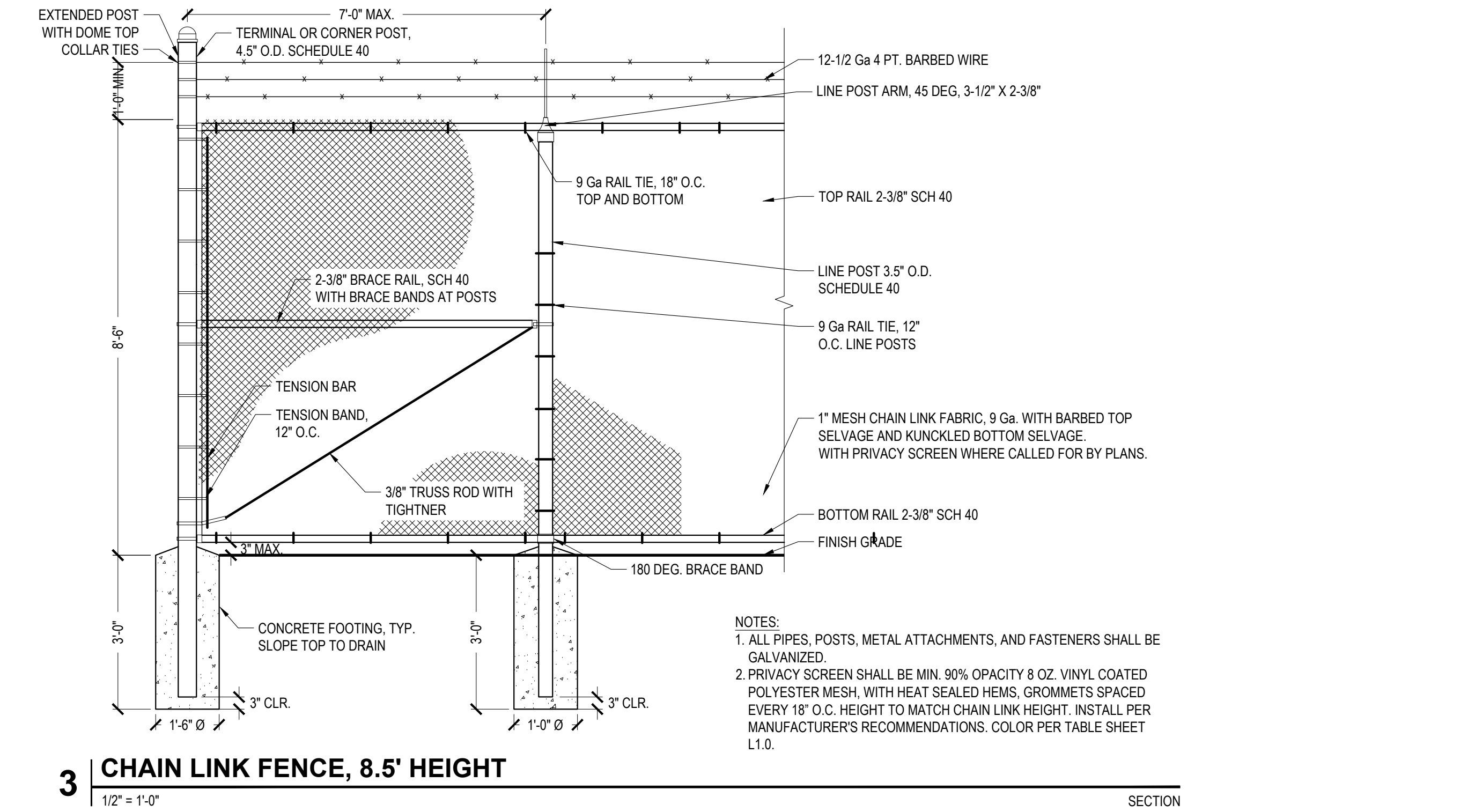
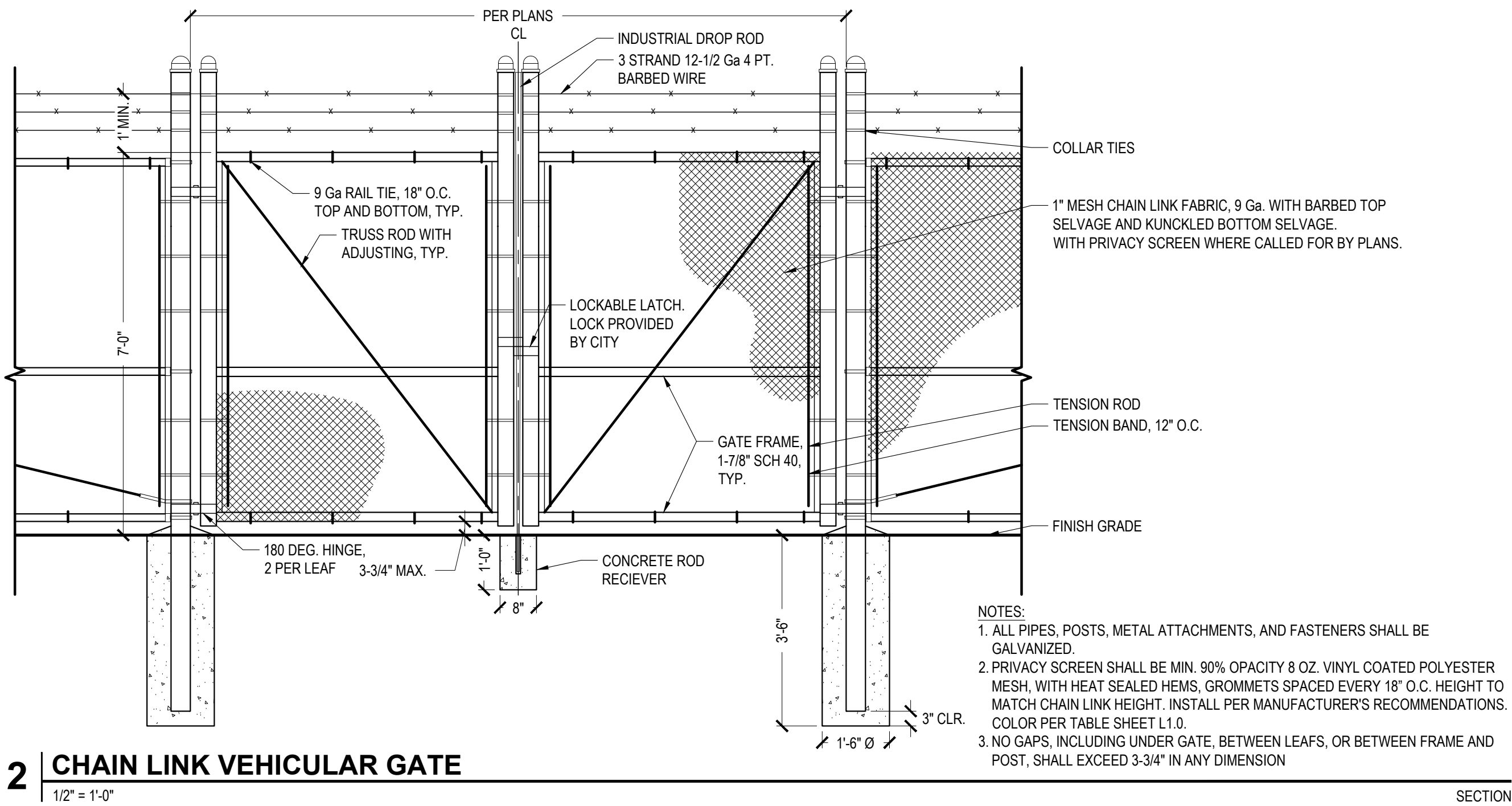
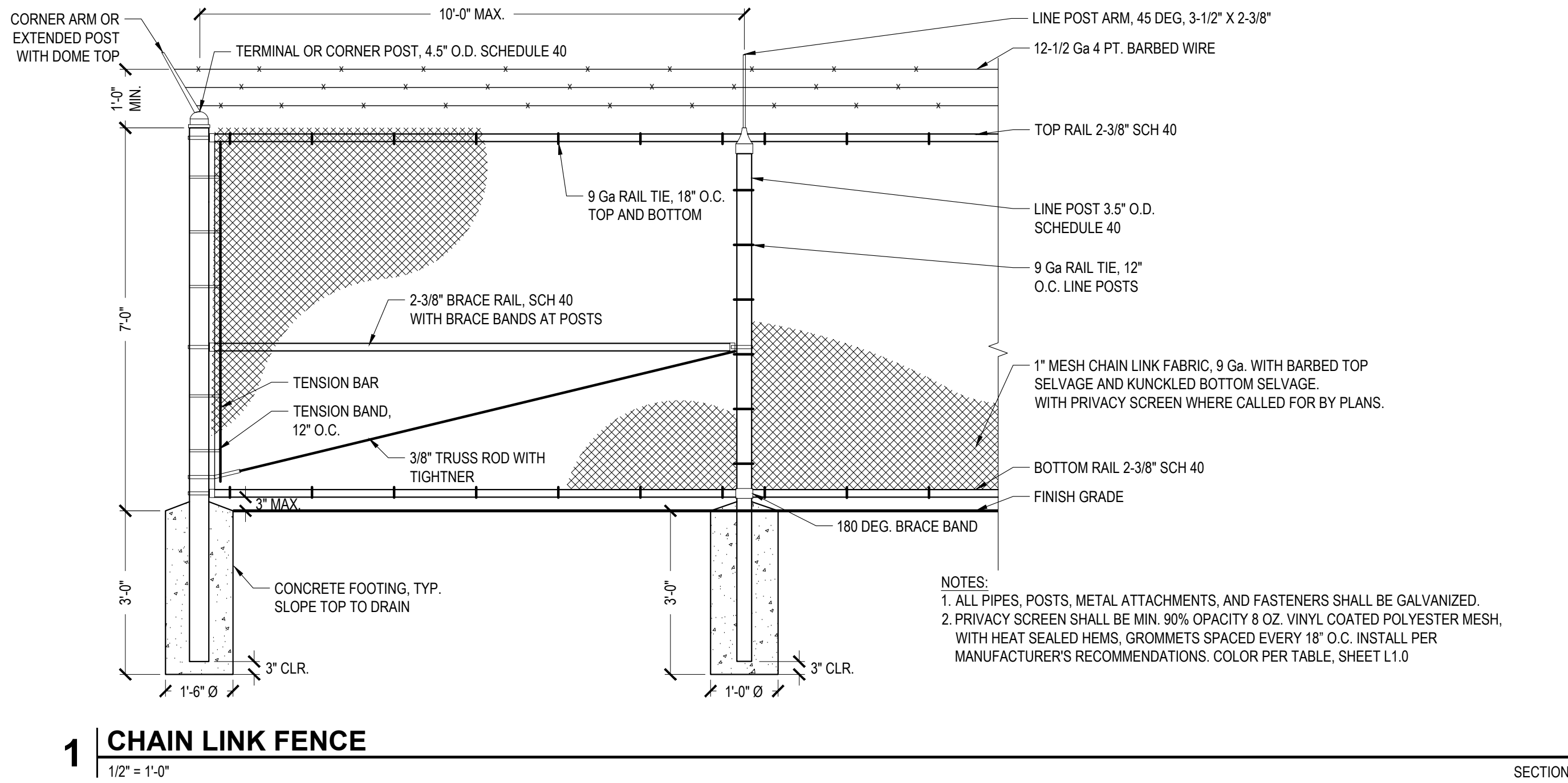

**NOTES**  
A. PAVEMENT DEPTHS AND REQUIREMENTS HEREIN ARE SUPERCEDED BY THE PROJECT GEOTECHNICAL REPORT AND RECOMMENDATIONS, IF EXISTING.

**5 CONCRETE PAVING (PEDESTRIAN)**

1" = 0'-6"

SECTION

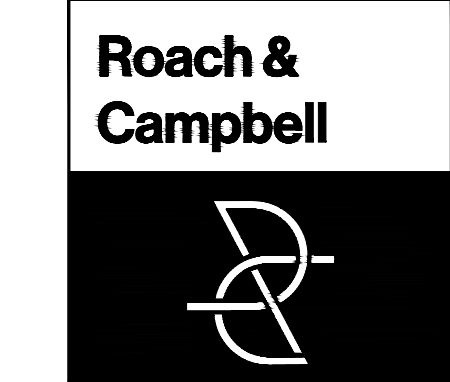

111 Scripps Drive  
Sacramento,  
California 95825  
916.945.8003 | 916.342.7119  
4409 CRLA 5044

## FENCE RETROFIT FOR

## FOLSOM ZOO SANCTUARY

### BY CITY OF FOLSOM

KEYMAP:

**CONSTRUCTION DETAILS**  
DRAWN BY:

CHECKED BY:

WMB

JOB NO.

23014

DATE

MAY 18, 2023

REVISIONS:

\_\_\_\_\_  
\_\_\_\_\_  
\_\_\_\_\_  
\_\_\_\_\_  
\_\_\_\_\_

\_\_\_\_\_  
\_\_\_\_\_  
\_\_\_\_\_  
\_\_\_\_\_  
\_\_\_\_\_

\_\_\_\_\_  
\_\_\_\_\_  
\_\_\_\_\_  
\_\_\_\_\_  
\_\_\_\_\_

DRAWINGS IN SET:

L2.1

9

FENCE  
RETROFIT  
FOR

FOLSOM  
ZOO  
SANCTUARY

BY CITY OF  
FOLSOM

KEYMAP:

CONSTRUCTION DETAILS

DRAWN BY:

JLL

CHECKED BY:

WMB

JOB NO.

23014

DATE

MAY 18, 2023

REVISIONS:

L2.2

DRAWINGS IN SET:

FIRST SUBMITTAL - NOT FOR CONSTRUCTION

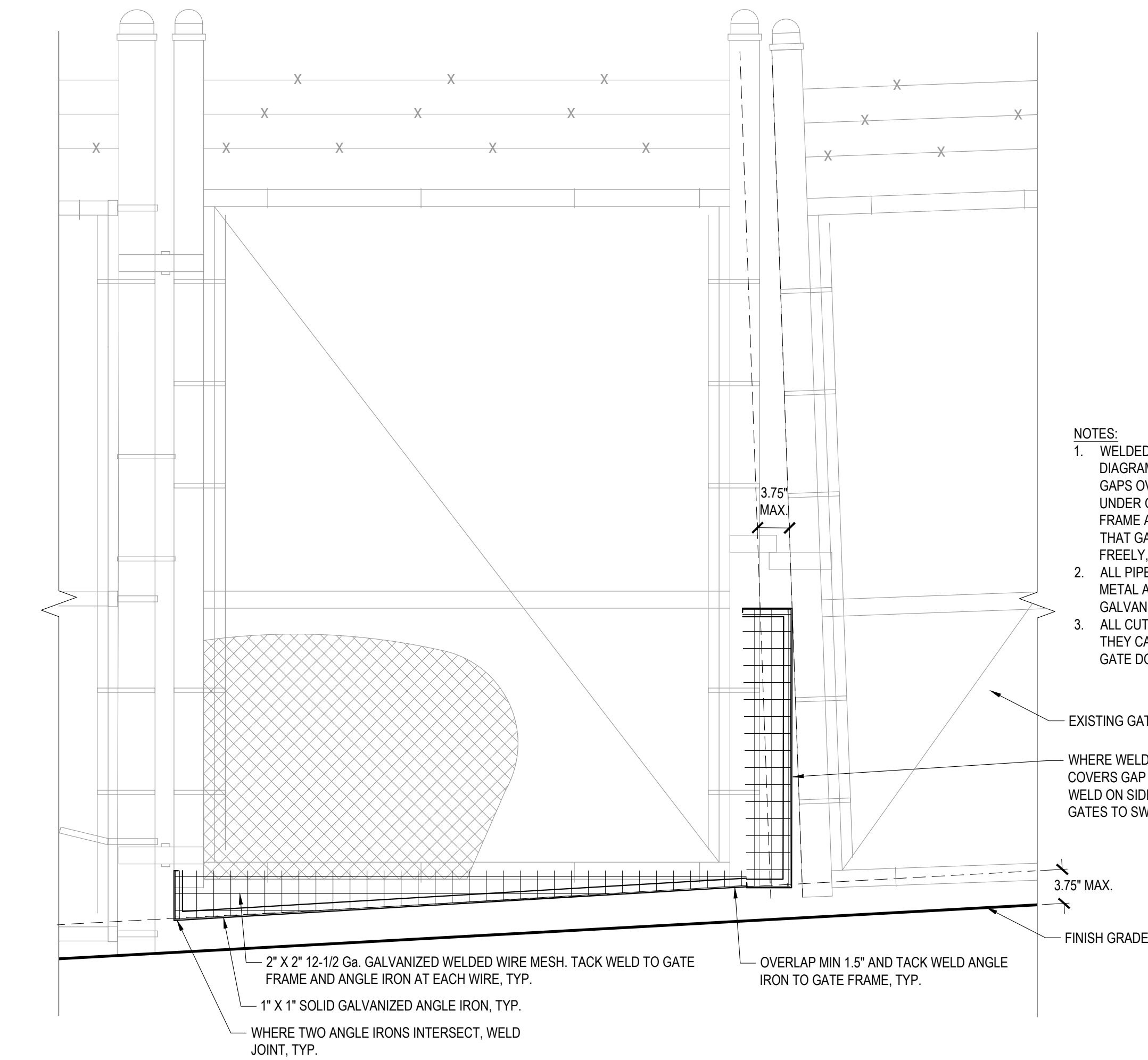

1 WELDED WIRE MESH PATCH ON EXISTING GATE

1\"/>

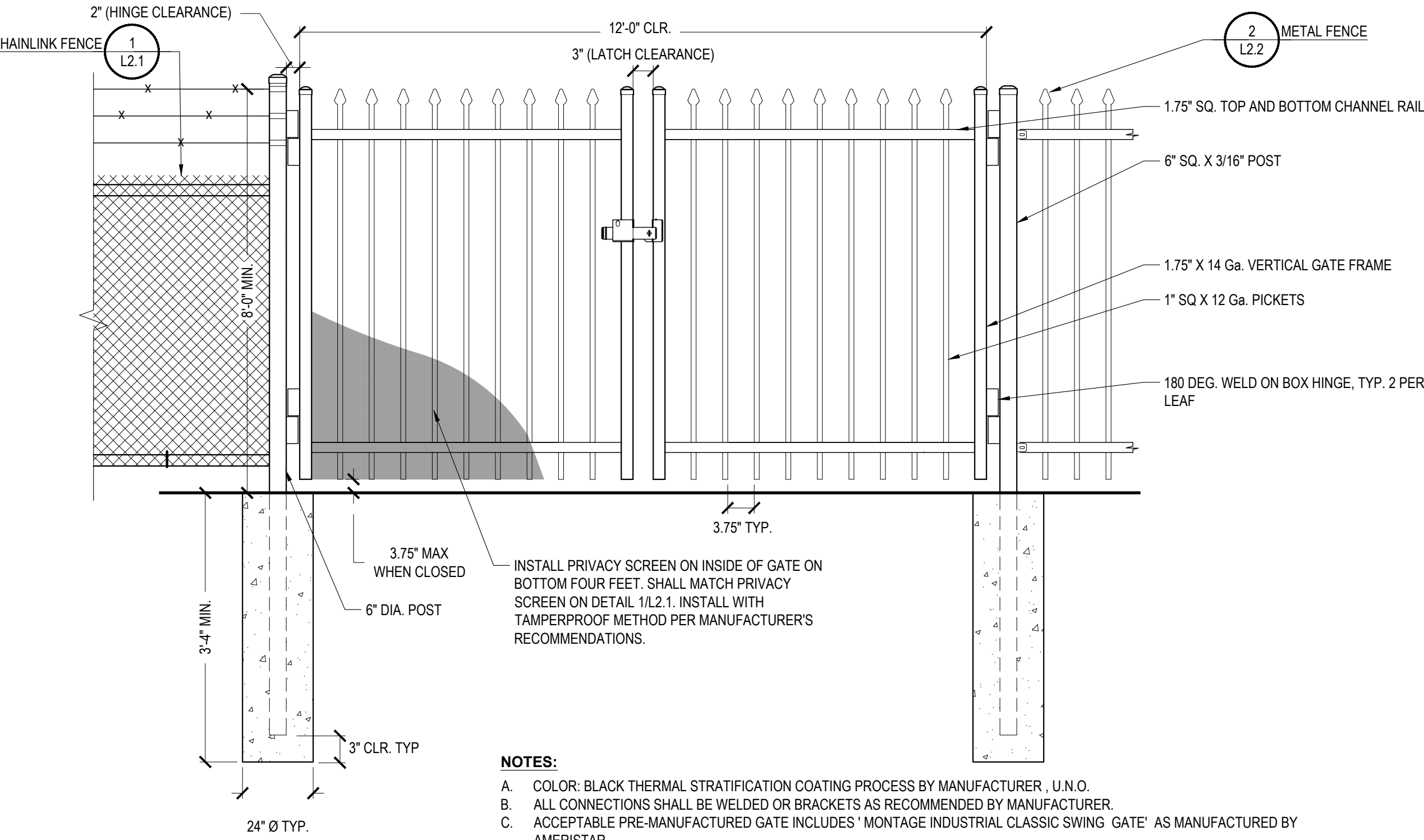

2 METAL SWING GATE

NO SCALE

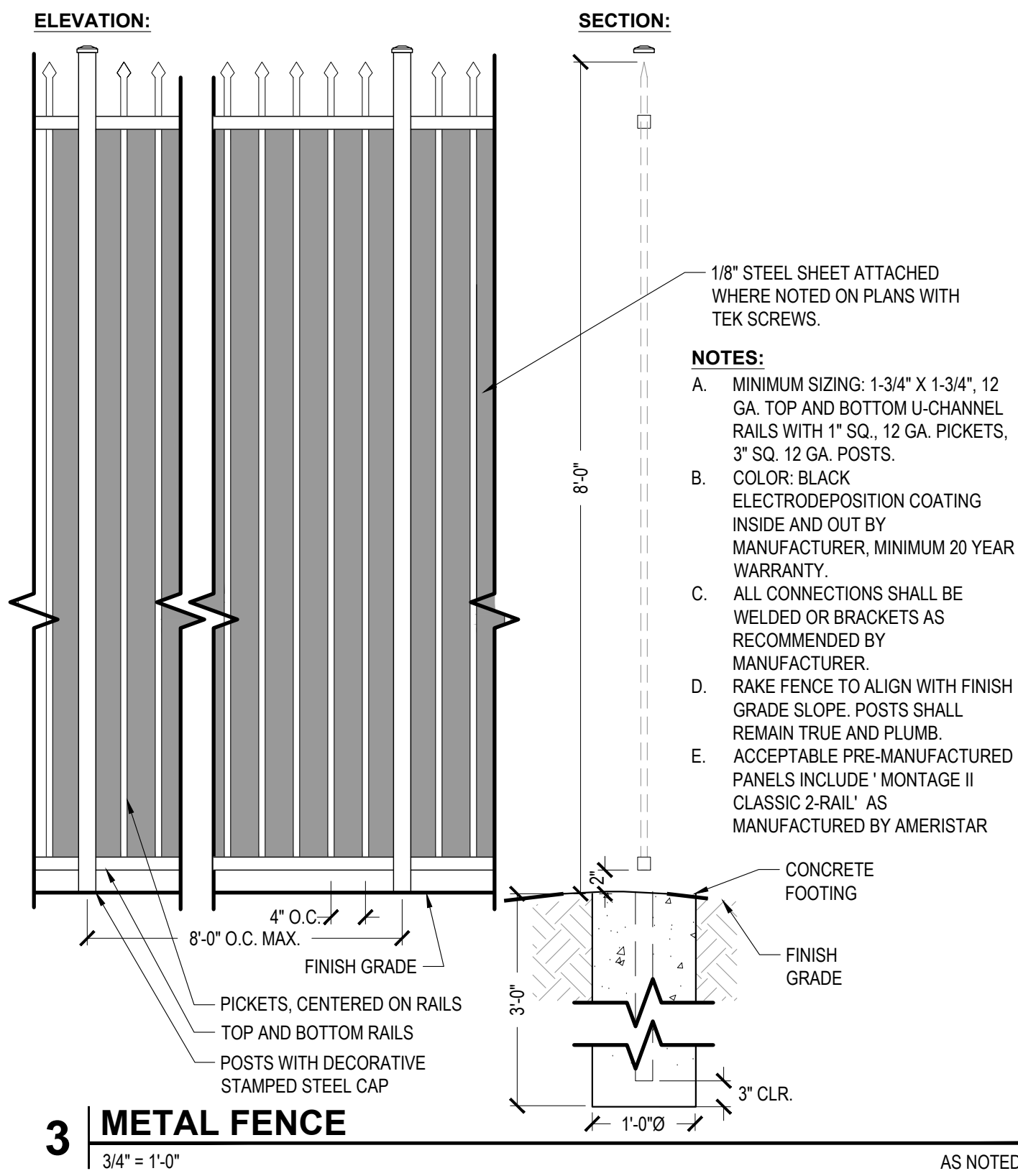

3 METAL FENCE

3/4\"/>

AS NOTED

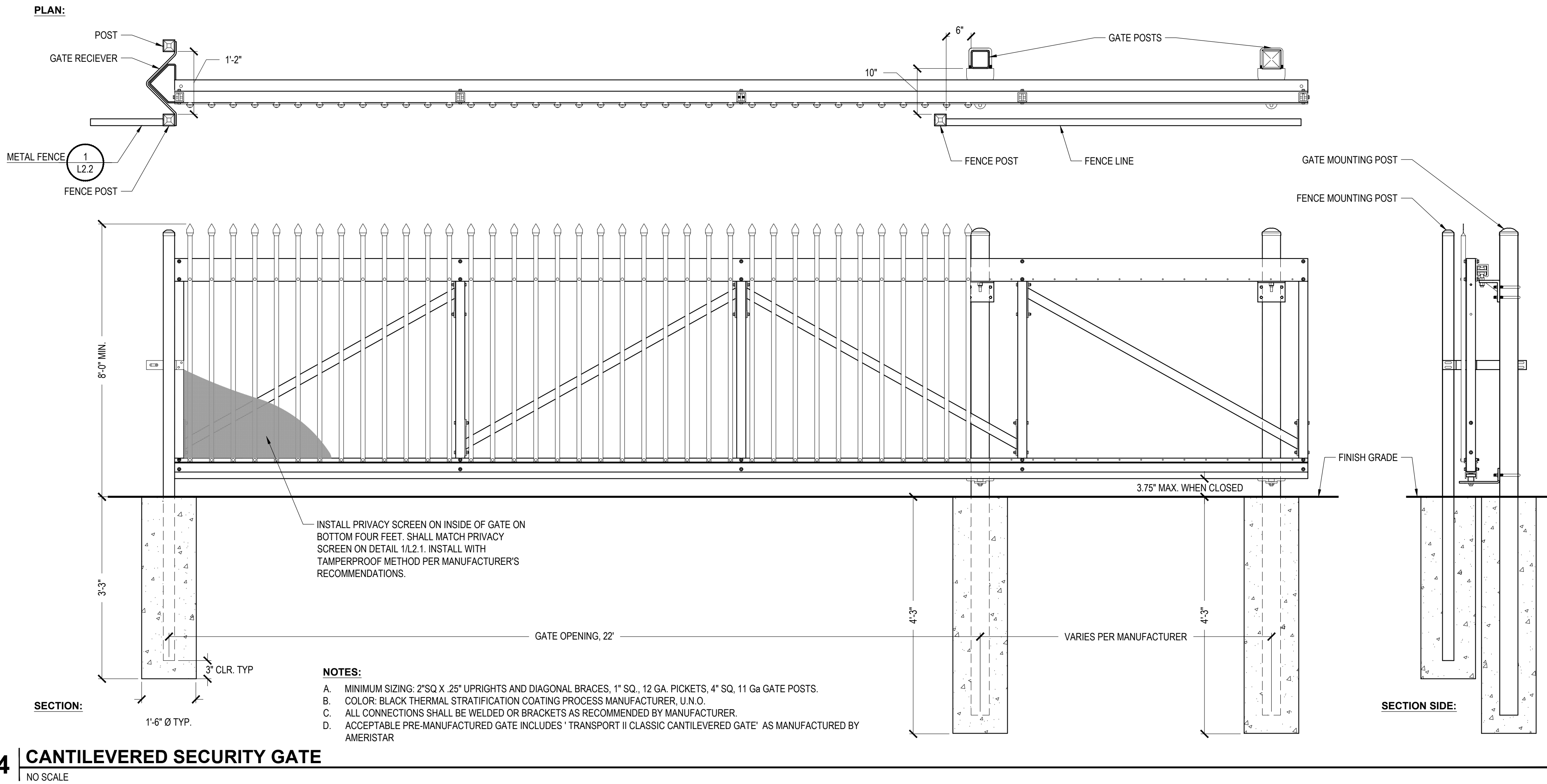

4 CANTILEVERED SECURITY GATE

NO SCALE

AS NOTED



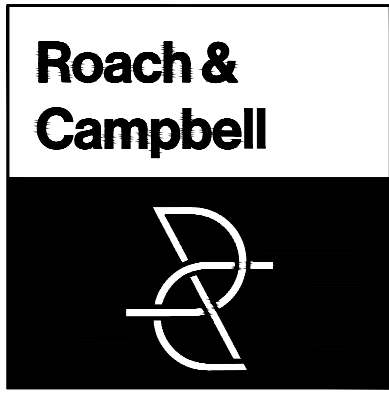

111 Scripps Drive  
Sacramento,  
California 95825  
916.945.8003 | 916.342.7119  
4409 CRLA 5044

FENCE  
RETROFIT  
FOR

FOLSOM  
ZOO  
SANCTUARY

BY CITY OF  
FOLSOM

KEYMAP:

CONSTRUCTION DETAILS

DRAWN BY:

JLL

CHECKED BY:

WMB

JOB NO.

23014

DATE

MAY 18, 2023

REVISIONS:

L2.3

DRAWINGS IN SET:

9

FIRST SUBMITTAL - NOT FOR CONSTRUCTION

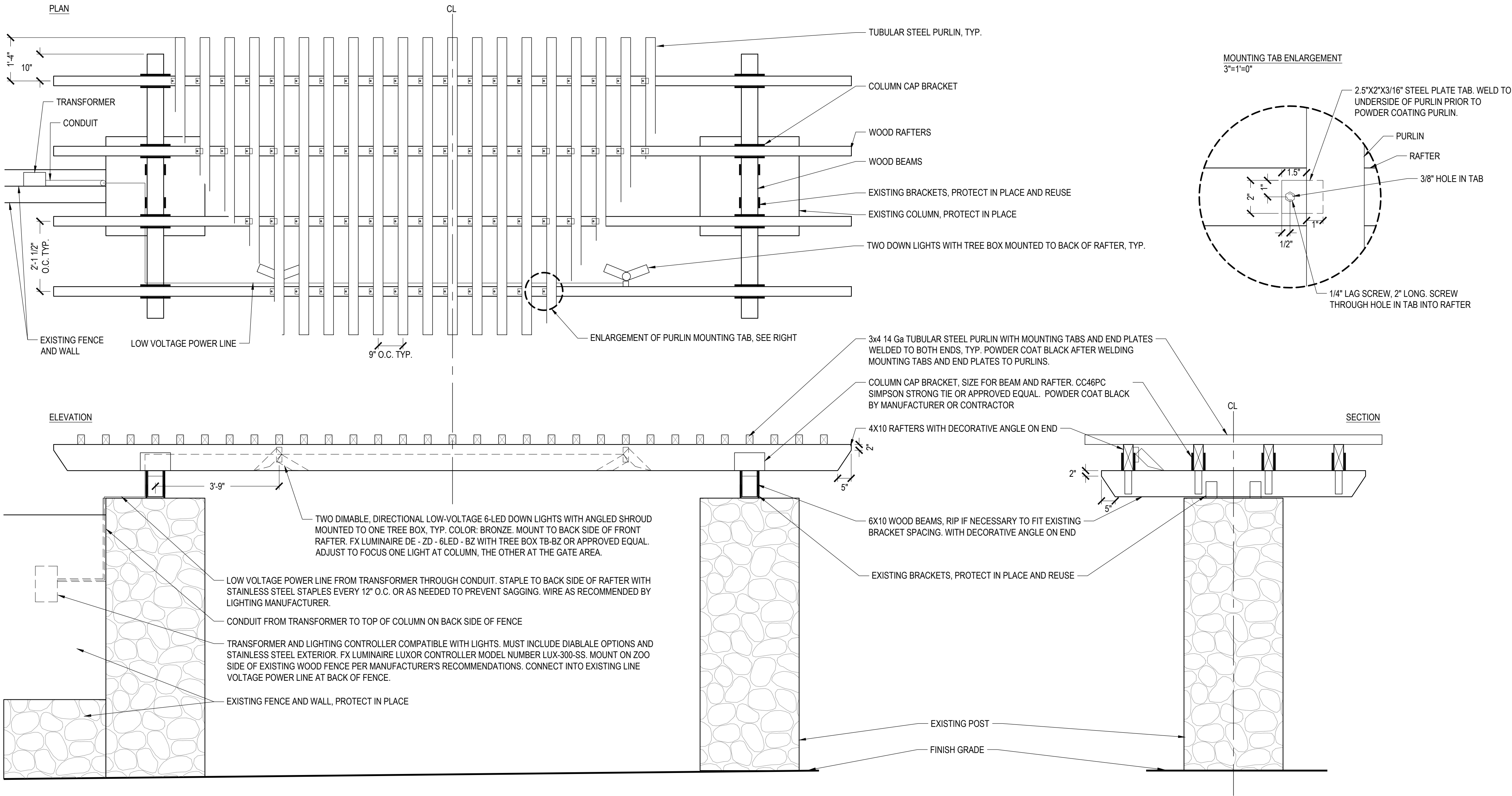

1 | MAIN ENTRANCE

1/2" = 1'-0"

SECTION